

ADVANTAGES OF THE TRAY SYSTEM TO POWER MACHINES

The system is designed to route installations in machine parks on production halls in places away from walls, columns and other structural elements. The system allows cable routing in a way that provides mechanical protection for the cables. Thanks to the use of hinged covers, it is possible to inspect the cables, which is particularly useful when it is necessary to quickly fix machine failures or expand the installation with additional circuits

1. 1.5 mm and 2.0 mm thick sheet metal makes the system resistant to mechanical damage and can be installed on the floor surface.
2. Additional cover supports eliminate deflection when walking on the trays.
3. Small size of the fittings makes it easy to route in limited spaces between machines.
4. System created based on our own experience in routing cables to production machines.
5. A complete system containing shaped elements, such as: elbows, tees, cross-overs, bends, reductions, covers, etc., allowing any formation of cable routes - this ensures speed and professionalism in installation, aesthetic qualities of the cable route as well as protection of cables from mechanical damage and dirt (covers).
6. Covers for machine power trays can have hinges and locks to quickly and easily access the cables and secure the lid from unwanted opening.
7. A wide range of dimensions: side height from 50 mm to 200 mm, width from 50 mm to 600 mm, sheet thickness from 1.5 mm to 2.0 mm - the ability to select the optimal tray for different needs results in a significant reduction in the price of the cable route.
8. A new slide-in tray insert for fixing cables in vertical sections. Cable fixing with UKZ clips, plastic ties, UDF clips, UEF clips.
9. Ensured electrical continuity of all types of trays KM, KMP, KMZ and all dimensions of trays confirmed by TÜV Rheinland and VDE certificates according to standards: PN-EN 61537:2007, DIN EN 61537:2007-9, BS-EN 61537:2007, EN 61537:2007.
10. Calculation modules on the website - the ability to quickly and optimally select a tray based on load and fill.
11. It is possible to manufacture trays in various coatings and materials: Sendzimir method galvanised steel according to PN-EN 10346:2015-09 (coating thickness approx. 19 µm), hot-dip galvanised steel according to PN-EN ISO 1461:2023-02 (up to 100 µm), electroplated (galvanised steel) according to PN-EN ISO 2081:2011, powder-coated galvanised steel, stainless steel 1.4301, 1.4044, 1.4571 (AISI grades: 304, 304L, 316, 316L, 316Ti and others), aluminium alloys - with such a wide range of materials and coatings, there are unlimited possibilities for use in any environment.
12. Fully automated production process of machine power supply cable trays and all system elements - thus ensuring high quality and repeatability of production with the precision of 0.1 mm
13. Technology and production quality at the highest level globally, thanks to the use of machinery from the best manufacturers on the market.
14. We produce from high quality materials, sheet metal, manufactured in Western European steel mills (Arcelor Mittal Eisenhuttenstadt, Arcelor Mittal Bremen, Arcelor Mittal Liege, Arcelor Mittal Gent) - high quality materials guarantee trouble-free and fast installation, long service life, uniform appearance of all products as well as conformity with safety standards in accordance with obtained certificates.
15. Design and manufacture of custom, non-standard trays and even entire systems complete with fittings and support structures. Any length, width, height, perforation, thickness, type of material and use of any colour do not limit the possibilities in creating aesthetically pleasing and innovative solutions. We are flexible and open to customer needs.
16. All production located in one place and our own hot-dip galvanising plant, flake galvanising plant and powder coating plant - this allows us to fully control the entire production process, maintain the highest quality of the product and reduce lead times.
17. All the necessary certificates and approvals for KM, KMP, KMZ trays:
 - TÜV Rheinland certification for mechanical strength
 - TÜV Rheinland and VDE certification for electrical continuity
 - TÜV Rheinland certification confirming compliance of the production quality management system with the ISO 9001:2015 standard EC Declaration of Conformity
 - TÜV Rheinland certification confirming compliance of the Environmental Management System with the ISO 14001:2015 standard.

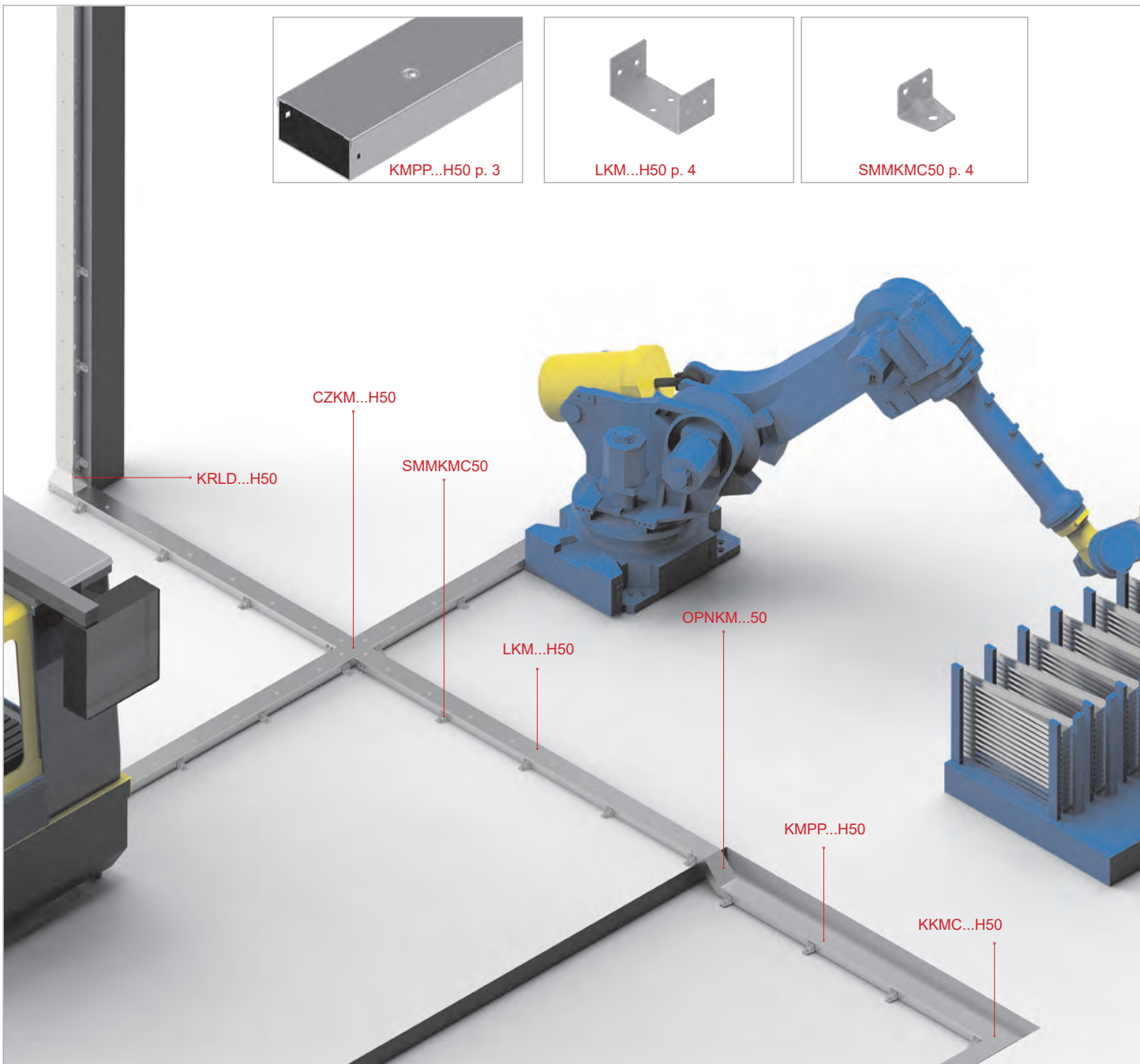





CABLE TRAYS - POWER SUPPLY TO MACHINES H50



Cable Tray	mat.: S	option: F, E		
code	catalogue number	dimension a/L [mm]	weight 1 m [kg]	quantity per package [m]
Material thickness = 1.5 mm				
KMZP50H50/2	812005	50/2000	3.00	4
KMZP100H50/2	812010	100/2000	4.20	4

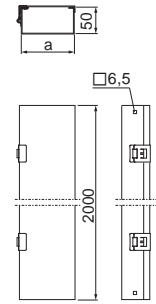

Cable Tray	mat.: S	option: F, E		
code	catalogue number	dimension a/L [mm]	weight 1 m [kg]	quantity per package [m]
Material thickness = 2.0 mm				
KMZC200H50/2	812120	200/2000	7.20	4
KMZC300H50/2	812130	300/2000	12.20	4
KMZC400H50/2	812140	400/2000	15.40	4
KMZC500H50/2	812150	500/2000	18.80	4
KMZC600H50/2	812160	600/2000	22.00	4



Additional information:
 – trays with hinges and covers included

Cable Tray	mat.: S	option: F, E		
code	catalogue number	dimension a/L [mm]	weight 1 m [kg]	quantity per package [m]
Material thickness = 1.5 mm				
KMPP50H50/2	810005	50/2000	3.00	4
KMPP100H50/2	810010	100/2000	4.20	4

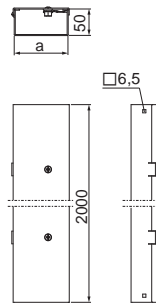

Cable Tray	mat.: S	option: F, E		
code	catalogue number	dimension a/L [mm]	weight 1 m [kg]	quantity per package [m]
Material thickness = 2.0 mm				
KMPC200H50/2	810120	200/2000	7.20	4
KMPC300H50/2	810130	300/2000	12.20	4
KMPC400H50/2	810140	400/2000	15.40	4
KMPC500H50/2	810150	500/2000	18.80	4
KMPC600H50/2	810160	600/2000	22.00	4



Use:
 Routing machine power supply cable routes.

Additional information:
 – trays with locking covers included

Cable Tray	KMP...H50	mat.: S	option: F, E		
code	catalogue number	dimension a/L [mm]	weight 1 m [kg]	quantity per package [m]	
Material thickness = 1.5 mm					
KMP50H50/2	810205	50/2000	2.10	4	
KMP100H50/2	810210	100/2000	2.71	4	
KMP200H50/2	810220	200/2000	3.95	4	
KMP300H50/2	810230	300/2000	5.19	4	
KMP400H50/2	810240	400/2000	6.42	4	
KMP500H50/2	810250	500/2000	7.66	4	
KMP600H50/2	810260	600/2000	8.90	4	

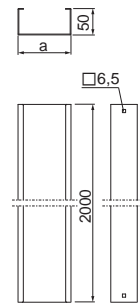

Cable Tray	KMC...H50	mat.: S	option: F, E		
code	catalogue number	dimension a/L [mm]	weight 1 m [kg]	quantity per package [m]	
Material thickness = 2.0 mm					
KMC50H50/2	810305	50/2000	2.80	4	
KMC100H50/2	810310	100/2000	3.62	4	
KMC200H50/2	810320	200/2000	5.27	4	
KMC300H50/2	810330	300/2000	6.92	4	
KMC400H50/2	810340	400/2000	8.56	4	
KMC500H50/2	810350	500/2000	10.21	4	
KMC600H50/2	810360	600/2000	11.86	4	

Use:

Routing machine power supply cable routes.

Additional information:

- on request it is possible to make trays of 3 m in length

Cable Tray Connector	LKMP...H50	mat.: S	option: F, E		
code	catalogue number	dimension a [mm]	weight 1 pc. [kg]	quantity per package [pcs.]	
Material thickness = 1.5 mm					
LKMP50H50	810405	45	0.11	2	
LKMP100H50	810410	95	0.21	2	

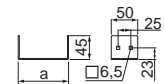

Cable Tray Connector	LKMC...H50	mat.: S	option: F, E		
code	catalogue number	dimension a [mm]	weight 1 pc. [kg]	quantity per package [pcs.]	
Material thickness = 2.0 mm					
LKMC200H50	810520	195	0.34	2	
LKMC300H50	810530	295	0.45	2	
LKMC400H50	810540	395	0.57	2	
LKMC500H50	810550	495	0.68	2	
LKMC600H50	810560	595	0.80	2	

Use:

Connecting trays and fittings.

Additional information:

- use SGK6x14 bolts for mounting with trays

Fastening Clamp	SMKMC50	mat.: S	option: FP, E		
code	catalogue number	weight 1 pc. [kg]	quantity per package [pcs.]		
Material thickness = 2.0 mm					
SMKMC50	810001	0.05	10		

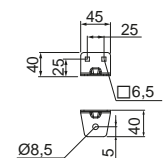

Use:

Mounting trays to the substrate.

Additional information:

- use SGK6x14 bolts for mounting with trays



CABLE TRAYS - POWER SUPPLY TO MACHINES H50



Horizontal Bend 90°

KPKMP...H50

mat.: S

option: F, E

code	catalogue number	dimension a [mm]	weight 1 pc. [kg]	quantity per package [pcs.]
Material thickness = 1.5 mm				
KPKMP50H50	810605	50	0.54	2
KPKMP100H50	810610	100	1.02	2

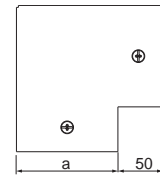

Horizontal Bend 90°

KKMC...H50

mat.: S

option: F, E

code	catalogue number	dimension a [mm]	weight 1 pc. [kg]	quantity per package [pcs.]
Material thickness = 2.0 mm				
KKMC200H50	810720	200	2.53	2
KKMC300H50	810730	300	4.64	2
KKMC400H50	810740	400	7.38	2
KKMC500H50	810750	500	10.75	2
KKMC600H50	810760	600	14.75	2



Horizontal Bend 45°

KKMMP...H50

mat.: S

option: F, E

code	catalogue number	dimension a [mm]	weight 1 pc. [kg]	quantity per package [pcs.]
Material thickness = 1.5 mm				
KKMMP50H50	810805	50	0.42	2
KKMMP100H50	810810	100	0.72	2

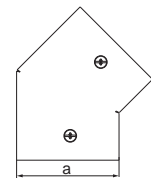

Horizontal Bend 45°

KKMMC...H50

mat.: S

option: F, E

code	catalogue number	dimension a [mm]	weight 1 pc. [kg]	quantity per package [pcs.]
Material thickness = 2.0 mm				
KKMMC200H50	810920	200	1.55	2
KKMMC300H50	810930	300	2.61	2
KKMMC400H50	810940	400	3.93	2
KKMMC500H50	810950	500	5.51	2
KKMMC600H50	810960	600	7.35	2



Use:

Changing the direction of the cable route.

Additional information:

- for the mounting fittings, use LKM connectors... and SGKM6x14 bolts
- fitting covers included

Horizontal Tee		TKMP...H50	mat.: S	option: F, E	
code	catalogue number	dimension a [mm]	weight 1 pc. [kg]	quantity per package [pcs.]	
Material thickness = 1.5 mm					
TKMP50H50	811005	50	0.64	2	
TKMP100H50	811010	100	1.16	2	

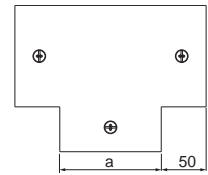

Horizontal Tee		TKMC...H50	mat.: S	option: F, E	
code	catalogue number	dimension a [mm]	weight 1 pc. [kg]	quantity per package [pcs.]	
Material thickness = 2.0 mm					
TKMC200H50	811120	200	2.75	2	
TKMC300H50	811130	300	4.91	2	
TKMC400H50	811140	400	7.70	2	
TKMC500H50	811150	500	11.13	2	
TKMC600H50	811160	600	15.18	2	



Use:

Branching of cable routes.

Additional information:

- for the mounting fittings, use LKM connectors... and SGKM6x14 bolts
- fitting covers included

Horizontal Cross-over		CZKMP...H50	mat.: S	option: F, E	
code	catalogue number	dimension a [mm]	weight 1 pc. [kg]	quantity per package [pcs.]	
Material thickness = 1.5 mm					
CZKMP50H50	811205	50	0.63	2	
CZKMP100H50	811210	100	1.04	2	

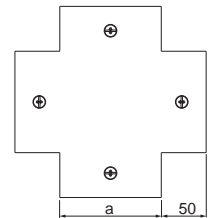

Horizontal Cross-over		CZKMC...H50	mat.: S	option: F, E	
code	catalogue number	dimension a [mm]	weight 1 pc. [kg]	quantity per package [pcs.]	
Material thickness = 2.0 mm					
CZKMC200H50	811320	200	3.18	2	
CZKMC300H50	811330	300	5.48	2	
CZKMC400H50	811340	400	8.39	2	
CZKMC500H50	811350	500	11.93	2	
CZKMC600H50	811360	600	16.11	2	



Use:

Branching of cable routes.

Additional information:

- for the mounting fittings, use LKM connectors... and SGKM6x14 bolts
- fitting covers included



Angle Reducer

RKKMP...H50

mat.: S

option: F, E

code	catalogue number	dimension a [mm]	weight 1 pc. [kg]	quantity per package [pcs.]
Material thickness = 1.5 mm				
RKKMP50H50	811805	50	0.08	2
RKKMP100H50	811810	100	0.12	2
RKKMP200H50	811820	200	0.21	2

Use:

Changing the width of the cable route.

Additional information:

- universal element
- possibility to form left and right reducer

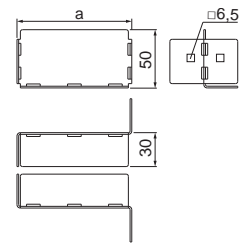

Straight Reducer

RSKMP...H50

mat.: S

option: F, E

code	catalogue number	dimension a/b [mm]	weight 1 pc. [kg]	quantity per package [pcs.]
Material thickness = 1.5 mm				
RSKMP100/50H50	811405	100/50	0.73	2
RSKMP200/100H50	811410	200/100	1.09	2

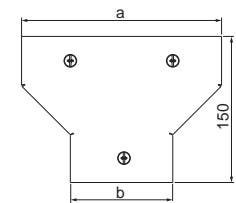

Straight Reducer

RSKMC...H50

mat.: S

option: F, E

code	catalogue number	dimension a/b [mm]	weight 1 pc. [kg]	quantity per package [pcs.]
Material thickness = 2.0 mm				
RSKMC300/200H50	811520	300/200	1.58	2
RSKMC400/300H50	811530	400/300	2.05	2
RSKMC500/400H50	811540	500/400	2.53	2
RSKMC600/500H50	811550	600/500	3.00	2



Use:

Changing the width of the cable route.

Additional information:

- for the mounting fittings, use LKM connectors... and SGK6x14 bolts
- fitting covers included

Horizontal Bypass OPZKMP...H50 mat.: S option: F, E

code	catalogue number	dimension a [mm]	weight 1 pc. [kg]	quantity per package [pcs.]
Material thickness = 1.5 mm				
OPZKMP50H50	811905	50	0.75	2
OPZKMP100H50	811910	100	1.63	2

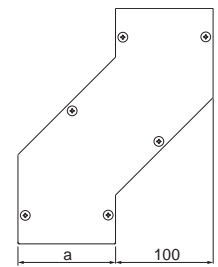

Horizontal Bypass OPZKMC...H50 mat.: S option: F, E

code	catalogue number	dimension a [mm]	weight 1 pc. [kg]	quantity per package [pcs.]
Material thickness = 2.0 mm				
OPZKMC200H50	812020	200	2.92	2
OPZKMC300H50	812030	300	4.00	2
OPZKMC400H50	812040	400	5.08	2
OPZKMC500H50	812050	500	6.16	2
OPZKMC600H50	812060	600	7.25	2



Vertical Bypass OPNKMP...H50 mat.: S option: F, E

code	catalogue number	dimension a [mm]	weight 1 pc. [kg]	quantity per package [pcs.]
Material thickness = 1.5 mm				
OPNKMP50H50	812105	50	1.00	2
OPNKMP100H50	812110	100	1.60	2

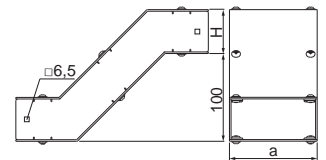

Vertical Bypass OPNKMC...H50 mat.: S option: F, E

code	catalogue number	dimension a [mm]	weight 1 pc. [kg]	quantity per package [pcs.]
Material thickness = 2.0 mm				
OPNKMC200H50	812220	200	3.02	2
OPNKMC300H50	812230	300	4.23	2
OPNKMC400H50	812240	400	5.44	2
OPNKMC500H50	812250	500	6.65	2
OPNKMC600H50	812260	600	7.86	2



Use:

Bypassing an obstacle along the cable route.

Additional information:

- for the mounting fittings, use LKM connectors... and SGKM6x14 bolts
- fitting covers included



90° Vertical Bend

LPKMP...H50 mat.: S option: F, E

code	catalogue number	dimension a [mm]	weight 1 pc. [kg]	quantity per package [pcs.]
Material thickness = 1.5 mm				
LPKMP50H50	812305	50	0.57	2
LPKMP100H50	812310	100	0.91	2

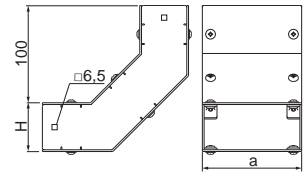

90° Vertical Bend

LPKMC...H50 mat.: S option: F, E

code	catalogue number	dimension a [mm]	weight 1 pc. [kg]	quantity per package [pcs.]
Material thickness = 2.0 mm				
LPKMC200H50	812420	200	1.70	2
LPKMC300H50	812430	300	2.36	2
LPKMC400H50	812440	400	3.03	2
LPKMC500H50	812450	500	3.70	2
LPKMC600H50	812460	600	4.36	2



45° Vertical Bend

LPKMMP...H50 mat.: S option: F, E

code	catalogue number	dimension a [mm]	weight 1 pc. [kg]	quantity per package [pcs.]
Material thickness = 1.5 mm				
LPKMMP50H50	812505	50	0.38	2
LPKMMP100H50	812510	100	0.60	2

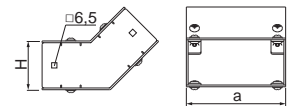

45° Vertical Bend

LPKMMC...H50 mat.: S option: F, E

code	catalogue number	dimension a [mm]	weight 1 pc. [kg]	quantity per package [pcs.]
Material thickness = 2.0 mm				
LPKMMC200H50	812620	200	1.13	2
LPKMMC300H50	812630	300	1.57	2
LPKMMC400H50	812640	400	2.01	2
LPKMMC500H50	812650	500	2.45	2
LPKMMC600H50	812660	600	2.89	2



Use:

Changing the direction of the cable route.

Additional information:

- for the mounting fittings, use LKM connectors... and SGKM6x14 bolts
- fitting covers included

Elbow - Right **KRPKMP...H50** mat.: S option: F, E

code	catalogue number	dimension a [mm]	weight 1 pc. [kg]	quantity per package [pcs.]
Material thickness = 1.5 mm				
KRPKMP50H50	812705	50	0.92	2
KRPKMP100H50	812710	100	1.55	2

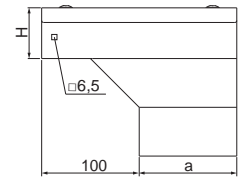

Elbow - Right **KRPKMC...H50** mat.: S option: F, E

code	catalogue number	dimension a [mm]	weight 1 pc. [kg]	quantity per package [pcs.]
Material thickness = 2.0 mm				
KRPKMC200H50	812820	200	3.31	2
KRPKMC300H50	812830	300	5.75	2
KRPKMC400H50	812840	400	8.88	2
KRPKMC500H50	812850	500	12.68	2
KRPKMC600H50	812860	600	17.16	2



Elbow - Left **KRLKMP...H50** mat.: S option: F, E

code	catalogue number	dimension a [mm]	weight 1 pc. [kg]	quantity per package [pcs.]
Material thickness = 1.5 mm				
KRLKMP50H50	812905	50	0.92	2
KRLKMP100H50	812910	100	1.55	2

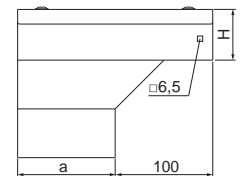

Elbow - Left **KRLKMC...H50** mat.: S option: F, E

code	catalogue number	dimension a [mm]	weight 1 pc. [kg]	quantity per package [pcs.]
Material thickness = 2.0 mm				
KRLKMC200H50	813020	200	3.31	2
KRLKMC300H50	813030	300	5.75	2
KRLKMC400H50	813040	400	8.88	2
KRLKMC500H50	813050	500	12.68	2
KRLKMC600H50	813060	600	17.16	2



Use:

Changing the direction of the cable route.

Additional information:

- for the mounting fittings, use LKM connectors... and SGKM6x14 bolts
- fitting covers included

Bottom Elbow - Right

KRPDMP...H50 mat.: S option: F, E

code	catalogue number	dimension a/H [mm]	weight 1 pc. [kg]	quantity per package [pcs.]
Material thickness = 1.5 mm				
KRPDMP50H50	818405	50/50	0.82	2
KRPDMP100H50	818410	100/50	1.41	2

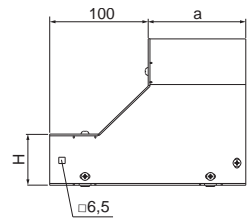

Bottom Elbow - Right

KRPDMC...H50 mat.: S option: F, E

code	catalogue number	dimension a [mm]	weight 1 pc. [kg]	quantity per package [pcs.]
Material thickness = 2.0 mm				
KRPDMC200H50	818420	200	3.08	2
KRPDMC300H50	818430	300	5.40	2
KRPDMC400H50	818440	400	8.38	2
KRPDMC500H50	818450	500	12.02	2
KRPDMC600H50	818460	600	16.32	2



Bottom Elbow - Left

KRLDMP...H50 mat.: S option: F, E

code	catalogue number	dimension a [mm]	weight 1 pc. [kg]	quantity per package [pcs.]
Material thickness = 1.5 mm				
KRLDMP50H50	818505	50	0.82	2
KRLDMP100H50	818510	100	1.41	2

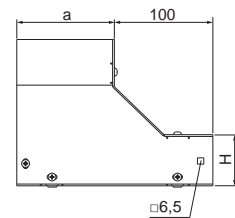

Bottom Elbow - Left

KRLDMC...H50 mat.: S option: F, E

code	catalogue number	dimension a [mm]	weight 1 pc. [kg]	quantity per package [pcs.]
Material thickness = 2.0 mm				
KRLDMC200H50	818520	200	3.08	2
KRLDMC300H50	818530	300	5.40	2
KRLDMC400H50	818540	400	8.38	2
KRLDMC500H50	818550	500	12.02	2
KRLDMC600H50	818560	600	16.32	2



Use:

Changing the direction of the cable route.

Additional information:

- for the mounting fittings, use LKM connectors... and SGKM6x14 bolts
- fitting covers included

Reduction tee **TRKMP...H50** mat.: S option: F, E

code	catalogue number	dimension a [mm]	weight 1 pc. [kg]	quantity per package [pcs.]
Material thickness = 1.5 mm				
TRKMP50H50	813105	50	1.53	2
TRKMP100H50	813110	100	2.19	2

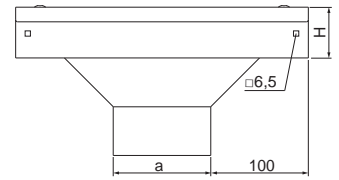

Reduction tee **TRKMC...H50** mat.: S option: F, E

code	catalogue number	dimension a [mm]	weight 1 pc. [kg]	quantity per package [pcs.]
Material thickness = 2.0 mm				
TRKMC200H50	813220	200	4.03	2
TRKMC300H50	813230	300	6.56	2
TRKMC400H50	813240	400	9.78	2
TRKMC500H50	813250	500	13.69	2
TRKMC600H50	813260	600	18.28	2



Bottom Tee - Lengthwise **TRSDMP...H50** mat.: S option: F, E

code	catalogue number	dimension a [mm]	weight 1 pc. [kg]	quantity per package [pcs.]
Material thickness = 1.5 mm				
TRSDMP50H50	818605	50	1.11	2
TRSDMP100H50	818610	100	1.57	2

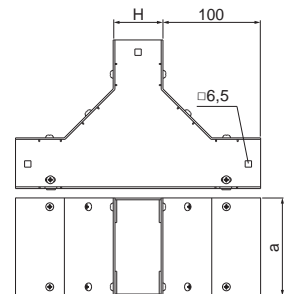

Bottom Tee - Lengthwise **TRSDMC...H50** mat.: S option: F, E

code	catalogue number	dimension a [mm]	weight 1 pc. [kg]	quantity per package [pcs.]
Material thickness = 2.0 mm				
TRSDMC200H50	818620	200	2.50	2
TRSDMC300H50	818630	300	3.42	2
TRSDMC400H50	818640	400	4.35	2
TRSDMC500H50	818650	500	5.27	2
TRSDMC600H50	818660	600	6.19	2

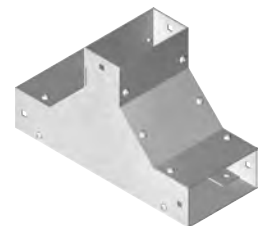

Use:

Branching of cable routes.

Additional information:

- for the mounting fittings, use LKM connectors... and SGKM6x14 bolts
- fitting covers included



CABLE TRAYS - POWER SUPPLY TO MACHINES H50



Add-on Tee		TDKMP...H50	mat.: S	option: F, E	
code	catalogue number	dimension a [mm]	weight 1 pc. [kg]	quantity per package [pcs.]	
Material thickness = 1.5 mm					
TDKMP50H50	811605	50	0.63	2	
TDKMP100H50	811610	100	0.80	2	

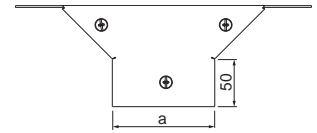

Add-on Tee		TDKMC...H50	mat.: S	option: F, E	
code	catalogue number	dimension a [mm]	weight 1 pc. [kg]	quantity per package [pcs.]	
Material thickness = 2.0 mm					
TDKMC200H50	811720	200	1.28	2	
TDKMC300H50	811730	300	1.61	2	
TDKMC400H50	811740	400	1.94	2	
TDKMC500H50	811750	500	2.27	2	
TDKMC600H50	811760	600	2.60	2	



Use:
Branching of cable routes.

- Additional information:**
- mounting with SGK M6x14 bolts
 - fitting covers included

Universal Tee		TRUNP...	mat.: S	option: F, E	
code	catalogue number	dimension a [mm]	weight 1 pc. [kg]	quantity per package [pcs.]	
Material thickness = 1.5 mm					
TRUNP100	819261	100	1.21	2	
TRUNP200	819262	200	2.38	2	
TRUNP300	819263	300	3.76	2	

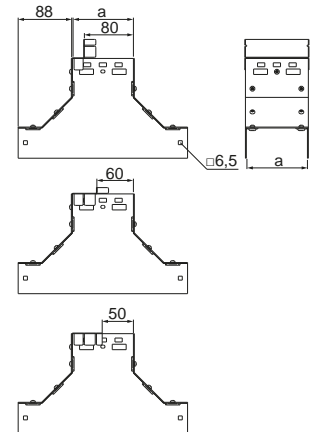

Use:
Branching of cable routes.

- Additional information:**
- mounting with SGK M6x14 bolts
 - mounting by placing on the tray from the top or bottom (after cutting out the bottom first)
 - the possibility of installing a reduction cover rotated in 90° increments allows you to leave with a cable tray or ladder with a height in the range of 50-100 mm in four positions

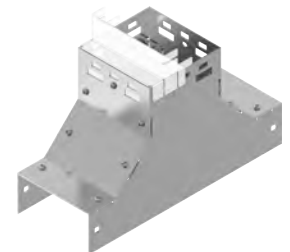

CABLE TRAYS - POWER SUPPLY TO MACHINES H100



Cable Tray		KMZP100H100		mat.: S	option: F, E
code	catalogue number	dimension a/L [mm]	weight 1 m [kg]	quantity per package [m]	

Material thickness = 1.5 mm

KMZP100H100/2	813810	100/2000	4.95	4	
---------------	--------	----------	------	---	--

Cable Tray		KMZC...H100		mat.: S	option: F, E
code	catalogue number	dimension a/L [mm]	weight 1 m [kg]	quantity per package [m]	

Material thickness = 2.0 mm

KMZC200H100/2	813920	200/2000	8.30	4	
KMZC300H100/2	813930	300/2000	10.35	4	
KMZC400H100/2	813940	400/2000	13.70	4	
KMZC500H100/2	813950	500/2000	16.60	4	
KMZC600H100/2	813960	600/2000	19.90	4	

Additional information:

- trays with hinges and covers included

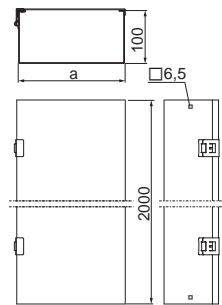

Cable Tray		KMPP100H100		mat.: S	option: F, E
code	catalogue number	dimension a/L [mm]	weight 1 m [kg]	quantity per package [m]	

Material thickness = 1.5 mm

KMPP100H100/2	813310	100/2000	4.95	4	
---------------	--------	----------	------	---	--

Cable Tray		KMPC...H100		mat.: S	option: F, E
code	catalogue number	dimension a/L [mm]	weight 1 m [kg]	quantity per package [m]	

Material thickness = 2.0 mm

KMPC200H100/2	813420	200/2000	8.30	4	
KMPC300H100/2	813430	300/2000	10.35	4	
KMPC400H100/2	813440	400/2000	13.70	4	
KMPC500H100/2	813450	500/2000	16.60	4	
KMPC600H100/2	813460	600/2000	19.90	4	

Use:

Routing machine power supply cable routes.

Additional information:

- trays with locking covers included

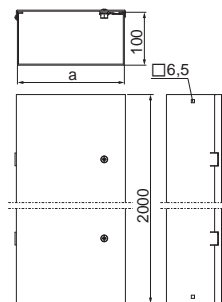

Cable Tray		KMP...H100	mat.: S	option: F, E	
code	catalogue number	dimension a/L [mm]	weight 1 m [kg]	quantity per package [m]	
Material thickness = 1.5 mm					
KMP100H100/2	813510	100/2000	3.95	4	
KMP200H100/2	813520	200/2000	5.19	4	
KMP300H100/2	813530	300/2000	6.42	4	
KMP400H100/2	813540	400/2000	7.66	4	
KMP500H100/2	813550	500/2000	8.89	4	
KMP600H100/2	813560	600/2000	10.13	4	

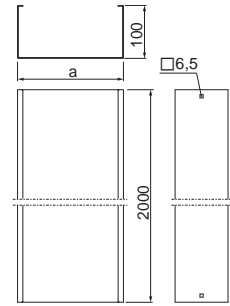

Cable Tray		KMC...H100	mat.: S	option: F, E	
code	catalogue number	dimension a/L [mm]	weight 1 m [kg]	quantity per package [m]	
Material thickness = 2.0 mm					
KMC100H100/2	813610	100/2000	5.27	4	
KMC200H100/2	813620	200/2000	6.92	4	
KMC300H100/2	813630	300/2000	8.56	4	
KMC400H100/2	813640	400/2000	10.24	4	
KMC500H100/2	813650	500/2000	11.86	4	
KMC600H100/2	813660	600/2000	13.51	4	



Use:
Routing machine power supply cable routes.

Additional information:
– on request it is possible to make trays of 3 m in length

Cable Tray Connector		LKMP100H100	mat.: S	option: F, E	
code	catalogue number	dimension a [mm]	weight 1 pc. [kg]	quantity per package [pcs.]	
Material thickness = 1.5 mm					
LKMP100H100	813710	95	0.36	2	

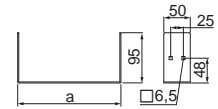

Cable Tray Connector		LKMC...H100	mat.: S	option: F, E	
code	catalogue number	dimension a [mm]	weight 1 pc. [kg]	quantity per package [pcs.]	
Material thickness = 2.0 mm					
LKMC200H100	813820	195	0.64	2	
LKMC300H100	813830	295	0.80	2	
LKMC400H100	813840	395	0.96	2	
LKMC500H100	813850	495	1.12	2	
LKMC600H100	813860	595	1.28	2	



Use:
Connecting trays and fittings.

Additional information:
– use SGK6x14 bolts for mounting with trays

Fastening Clamp		SMKMC100	mat.: S	option: FP, E	
code	catalogue number	weight 1 pc. [kg]	quantity per package [pcs.]		
Material thickness = 2.0 mm					
SMKMC100	810002	0.07	10		

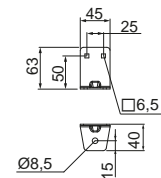

Use:
Mounting trays to the substrate.

Additional information:
– use SGK6x14 bolts for mounting with trays



Horizontal Bend 90° **KPKMP100H100** mat.: S option: F, E

code	catalogue number	dimension a [mm]	weight 1 pc. [kg]	quantity per package [pcs.]
Material thickness = 1.5 mm				
KPKMP100H100	813910	100	1.32	2

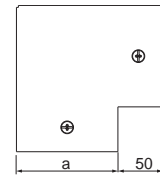

Horizontal Bend 90° **KKMC...H100** mat.: S option: F, E

code	catalogue number	dimension a [mm]	weight 1 pc. [kg]	quantity per package [pcs.]
Material thickness = 2.0 mm				
KKMC200H100	814020	200	3.00	2
KKMC300H100	814030	300	5.27	2
KKMC400H100	814040	400	8.16	2
KKMC500H100	814050	500	11.69	2
KKMC600H100	814060	600	15.85	2



Horizontal Bend 45° **KKMMP100H100** mat.: S option: F, E

code	catalogue number	dimension a [mm]	weight 1 pc. [kg]	quantity per package [pcs.]
Material thickness = 1.5 mm				
KKMMP100H100	814110	100	0.92	2

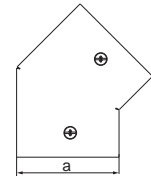

Horizontal Bend 45° **KKMMC...H100** mat.: S option: F, E

code	catalogue number	dimension a [mm]	weight 1 pc. [kg]	quantity per package [pcs.]
Material thickness = 2.0 mm				
KKMMC200H100	814220	200	1.84	2
KKMMC300H100	814230	300	2.96	2
KKMMC400H100	814240	400	4.35	2
KKMMC500H100	814250	500	6.00	2
KKMMC600H100	814260	600	7.91	2



Use:

Changing the direction of the cable route.

Additional information:

- for the mounting fittings, use LKM connectors... and SGK6x14 bolts
- fitting covers included



Horizontal Tee

TKMP100H100

mat.: S option: F, E

code	catalogue number	dimension a [mm]	weight 1 pc. [kg]	quantity per package [pcs.]
------	------------------	------------------	-------------------	-----------------------------

Material thickness = 1.5 mm

TKMP100H100	814310	100	1.43	2
-------------	--------	-----	------	---

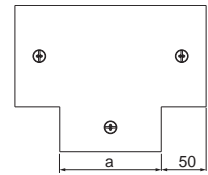

Horizontal Tee

TKMC...H100

mat.: S option: F, E

code	catalogue number	dimension a [mm]	weight 1 pc. [kg]	quantity per package [pcs.]
------	------------------	------------------	-------------------	-----------------------------

Material thickness = 2.0 mm

TKMC200H100	814420	200	3.15	2
TKMC300H100	814430	300	5.39	2
TKMC400H100	814440	400	8.26	2
TKMC500H100	814450	500	11.76	2
TKMC600H100	814460	600	15.89	2



Use:

Branching of cable routes.

Additional information:

- for the mounting fittings, use LKM connectors... and SGKM6x14 bolts
- fitting covers included

Horizontal Cross-over

CZKMP100H100

mat.: S option: F, E

code	catalogue number	dimension a [mm]	weight 1 pc. [kg]	quantity per package [pcs.]
------	------------------	------------------	-------------------	-----------------------------

Material thickness = 1.5 mm

CZKMP100H100	814510	100	1.26	2
--------------	--------	-----	------	---

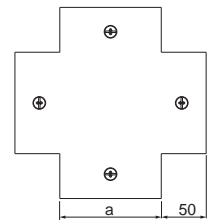

Horizontal Cross-over

CZKMC...H100

mat.: S option: F, E

code	catalogue number	dimension a [mm]	weight 1 pc. [kg]	quantity per package [pcs.]
------	------------------	------------------	-------------------	-----------------------------

Material thickness = 2.0 mm

CZKMC200H100	814620	200	3.50	2
CZKMC300H100	814630	300	5.80	2
CZKMC400H100	814640	400	8.70	2
CZKMC500H100	814650	500	12.25	2
CZKMC600H100	814660	600	16.43	2



Use:

Branching of cable routes.

Additional information:

- for the mounting fittings, use LKM connectors... and SGKM6x14 bolts
- fitting covers included

Angle Reducer

RKKMP...H100

mat.: S

option: F, E

code	catalogue number	dimension a [mm]	weight 1 pc. [kg]	quantity per package [pcs.]
Material thickness = 1.5 mm				
RKKMP100H100	815110	100	0.23	2
RKKMP200H100	815120	200	0.40	2

Additional information:

- universal element
- possibility to form left and right reducer

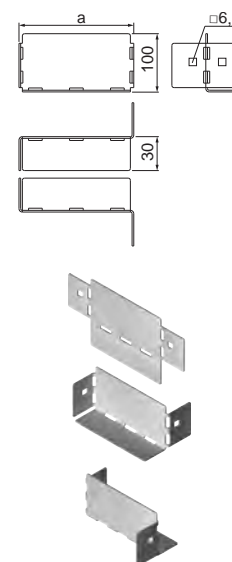

Straight Reducer

RSKMP200/100H100

mat.: S

option: F, E

code	catalogue number	dimension a/b [mm]	weight 1 pc. [kg]	quantity per package [pcs.]
Material thickness = 1.5 mm				
RSKMP200/100H100	814710	200/100	1.38	2

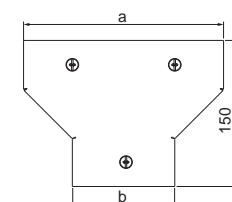

Straight Reducer

RSKMC...H100

mat.: S

option: F, E

code	catalogue number	dimension a/b [mm]	weight 1 pc. [kg]	quantity per package [pcs.]
Material thickness = 2.0 mm				
RSKMC300/200H100	814820	300/200	1.86	2
RSKMC400/300H100	814830	400/300	2.33	2
RSKMC500/400H100	814840	500/400	2.80	2
RSKMC600/500H100	814850	600/500	3.28	2



Use:

Changing the width of the cable route.

Additional information:

- for the mounting fittings, use LKM connectors... and SGKM6x14 bolts
- fitting covers included



Horizontal Bypass

OPZKMP100H100 mat.: S option: F, E

code	catalogue number	dimension a [mm]	weight 1 pc. [kg]	quantity per package [pcs.]
------	------------------	------------------	-------------------	-----------------------------

Material thickness = 1.5 mm

OPZKMP100H100	815210	100	2.03	2
---------------	--------	-----	------	---

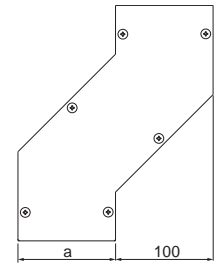

Horizontal Bypass

OPZKMC...H100 mat.: S option: F, E

code	catalogue number	dimension a [mm]	weight 1 pc. [kg]	quantity per package [pcs.]
------	------------------	------------------	-------------------	-----------------------------

Material thickness = 2.0 mm

OPZKMC200H100	815320	200	3.52	2
OPZKMC300H100	815330	300	4.61	2
OPZKMC400H100	815340	400	5.69	2
OPZKMC500H100	815350	500	6.77	2
OPZKMC600H100	815360	600	7.85	2



Vertical Bypass

OPNKMP100H100 mat.: S option: F, E

code	catalogue number	dimension a [mm]	weight 1 pc. [kg]	quantity per package [pcs.]
------	------------------	------------------	-------------------	-----------------------------

Material thickness = 1.5 mm

OPNKMP100H100	815410	100	2.03	2
---------------	--------	-----	------	---

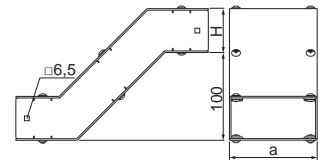

Vertical Bypass

OPNKMC...H100 mat.: S option: F, E

code	catalogue number	dimension a [mm]	weight 1 pc. [kg]	quantity per package [pcs.]
------	------------------	------------------	-------------------	-----------------------------

Material thickness = 2.0 mm

OPNKMC200H100	815520	200	3.65	2
OPNKMC300H100	815530	300	4.87	2
OPNKMC400H100	815540	400	6.08	2
OPNKMC500H100	815550	500	7.29	2
OPNKMC600H100	815560	600	8.50	2



Use:

Bypassing an obstacle along the cable route.

Additional information:

- for the mounting fittings, use LKM connectors... and SGKM6x14 bolts
- fitting covers included

90° Vertical Bend

LPKMP100H100 mat.: S option: F, E

code	catalogue number	dimension a [mm]	weight 1 pc. [kg]	quantity per package [pcs.]
------	------------------	------------------	-------------------	-----------------------------

Material thickness = 1.5 mm

LPKMP100H100	815610	100	1.34	2
--------------	--------	-----	------	---

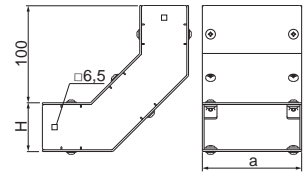

90° Vertical Bend

LPKMC...H100 mat.: S option: F, E

code	catalogue number	dimension a [mm]	weight 1 pc. [kg]	quantity per package [pcs.]
------	------------------	------------------	-------------------	-----------------------------

Material thickness = 2.0 mm

LPKMC200H100	815720	200	2.42	2
LPKMC300H100	815730	300	3.21	2
LPKMC400H100	815740	400	4.01	2
LPKMC500H100	815750	500	4.80	2
LPKMC600H100	815760	600	5.60	2



45° Vertical Bend

LPKMMP100H100 mat.: S option: F, E

code	catalogue number	dimension a [mm]	weight 1 pc. [kg]	quantity per package [pcs.]
------	------------------	------------------	-------------------	-----------------------------

Material thickness = 1.5 mm

LPKMMP100H100	815810	100	0.85	2
---------------	--------	-----	------	---

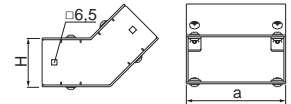

45° Vertical Bend

LPKMMC...H100 mat.: S option: F, E

code	catalogue number	dimension a [mm]	weight 1 pc. [kg]	quantity per package [pcs.]
------	------------------	------------------	-------------------	-----------------------------

Material thickness = 2.0 mm

LPKMMC200H100	815920	200	1.54	2
LPKMMC300H100	815930	300	2.05	2
LPKMMC400H100	815940	400	2.56	2
LPKMMC500H100	815950	500	3.06	2
LPKMMC600H100	815960	600	3.57	2



Use:

Changing the direction of the cable route.

Additional information:

- for the mounting fittings, use LKM connectors... and SGKM6x14 bolts
- fitting covers included



CABLE TRAYS - POWER SUPPLY TO MACHINES H100



Elbow - Right

KRPKMP100H100 mat.: S option: F, E

code	catalogue number	dimension a [mm]	weight 1 pc. [kg]	quantity per package [pcs.]
------	------------------	------------------	-------------------	-----------------------------

Material thickness = 1.5 mm

KRPKMP100H100	816010	100	2.02	2
----------------------	---------------	-----	------	---

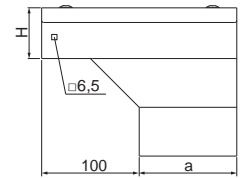

Elbow - Right

KRPKMC...H100 mat.: S option: F, E

code	catalogue number	dimension a [mm]	weight 1 pc. [kg]	quantity per package [pcs.]
------	------------------	------------------	-------------------	-----------------------------

Material thickness = 2.0 mm

KRPKMC200H100	816120	200	3.88	2
KRPKMC300H100	816130	300	6.43	2
KRPKMC400H100	816140	400	9.62	2
KRPKMC500H100	816150	500	13.44	2
KRPKMC600H100	816160	600	17.91	2



Elbow - Left

KRLKMP100H100 mat.: S option: F, E

code	catalogue number	dimension a [mm]	weight 1 pc. [kg]	quantity per package [pcs.]
------	------------------	------------------	-------------------	-----------------------------

Material thickness = 1.5 mm

KRLKMP100H100	816210	100	2.02	2
----------------------	---------------	-----	------	---

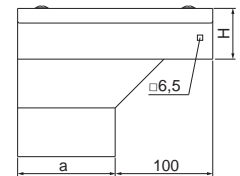

Elbow - Left

KRLKMC...H100 mat.: S option: F, E

code	catalogue number	dimension a [mm]	weight 1 pc. [kg]	quantity per package [pcs.]
------	------------------	------------------	-------------------	-----------------------------

Material thickness = 2.0 mm

KRLKMC200H100	816320	200	3.88	2
KRLKMC300H100	816330	300	6.43	2
KRLKMC400H100	816340	400	9.62	2
KRLKMC500H100	816350	500	13.44	2
KRLKMC600H100	816360	600	17.91	2



Use:

Changing the direction of the cable route.

Additional information:

- for the mounting fittings, use LKM connectors... and SGKM6x14 bolts
- fitting covers included

Bottom Elbow - Right **KRPDMP100H100** mat.: S option: F, E

code	catalogue number	dimension a [mm]	weight 1 pc. [kg]	quantity per package [pcs.]
Material thickness = 1.5 mm				
	818710	100	1.89	2

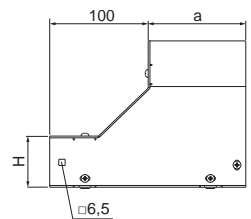

Bottom Elbow - Right **KRPDMC...H100** mat.: S option: F, E

code	catalogue number	dimension a [mm]	weight 1 pc. [kg]	quantity per package [pcs.]
Material thickness = 2.0 mm				



KRPDMC200H100	818720	200	3.72	2
KRPDMC300H100	818730	300	6.37	2
KRPDMC400H100	818740	400	9.61	2
KRPDMC500H100	818750	500	13.42	2
KRPDMC600H100	818760	600	17.74	2

Bottom Elbow - Left **KRLDMP100H100** mat.: S option: F, E

code	catalogue number	dimension a [mm]	weight 1 pc. [kg]	quantity per package [pcs.]
Material thickness = 1.5 mm				
	818810	100	1.89	2

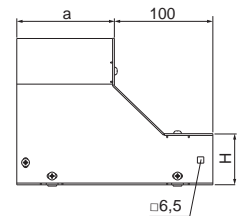

Bottom Elbow - Left **KRLDMC...H100** mat.: S option: F, E

code	catalogue number	dimension a [mm]	weight 1 pc. [kg]	quantity per package [pcs.]
Material thickness = 2.0 mm				



KRLDMC200H100	818820	200	3.72	2
KRLDMC300H100	818830	300	6.37	2
KRLDMC400H100	818840	400	9.61	2
KRLDMC500H100	818850	500	13.42	2
KRLDMC600H100	818860	600	17.74	2

Use:

Changing the direction of the cable route.

Additional information:

- for the mounting fittings, use LKM connectors... and SGKM6x14 bolts
- fitting covers included



Reduction tee **TRKMP100H100** mat.: S option: F, E

code	catalogue number	dimension a [mm]	weight 1 pc. [kg]	quantity per package [pcs.]
Material thickness = 1.5 mm				
TRKMP100H100	816510	100	2.58	2

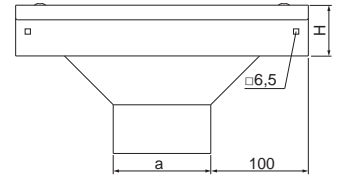

Reduction tee **TRKMC...H100** mat.: S option: F, E

code	catalogue number	dimension a [mm]	weight 1 pc. [kg]	quantity per package [pcs.]
Material thickness = 2.0 mm				
TRKMC200H100	816520	200	4.55	2
TRKMC300H100	816530	300	7.25	2
TRKMC400H100	816540	400	10.68	2
TRKMC500H100	816550	500	14.83	2
TRKMC600H100	816560	600	19.71	2



Bottom Tee - Lengthwise **TRSDMP100H100** mat.: S option: F, E

code	catalogue number	dimension a [mm]	weight 1 pc. [kg]	quantity per package [pcs.]
Material thickness = 1.5 mm				
TRSDMP100H100	818910	100	2.13	2

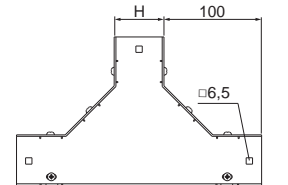

Bottom Tee - Lengthwise **TRSDMC...H100** mat.: S option: F, E

code	catalogue number	dimension a [mm]	weight 1 pc. [kg]	quantity per package [pcs.]
Material thickness = 2.0 mm				
TRSDMC200H100	818920	200	3.36	2
TRSDMC300H100	818930	300	4.36	2
TRSDMC400H100	818940	400	5.37	2
TRSDMC500H100	818950	500	6.37	2
TRSDMC600H100	818960	600	7.38	2

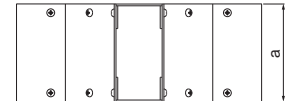

Use:

Branching of cable routes.

Additional information:

- for the mounting fittings, use LKM connectors... and SGKM6x14 bolts
- fitting covers included

Add-on Tee **TDKMP100H100** mat.: S option: F, E

code	catalogue number	dimension a [mm]	weight 1 pc. [kg]	quantity per package [pcs.]
Material thickness = 1.5 mm				
TDKMP100H100	814910	100	0.87	2

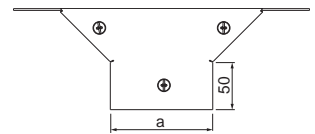

Add-on Tee **TDKMC...H100** mat.: S option: F, E

code	catalogue number	dimension a [mm]	weight 1 pc. [kg]	quantity per package [pcs.]
Material thickness = 2.0 mm				
TDKMC200H100	815020	200	1.40	2
TDKMC300H100	815030	300	1.72	2
TDKMC400H100	815040	400	2.05	2
TDKMC500H100	815050	500	2.38	2
TDKMC600H100	815060	600	2.71	2



Use:
Branching of cable routes.

Additional information:

- mounting with SGK6x14 bolts
- fitting covers included

Universal Tee **TRUNP...** mat.: S option: F, E

code	catalogue number	dimension a [mm]	weight 1 pc. [kg]	quantity per package [pcs.]
Material thickness = 1.5 mm				
TRUNP100	819261	100	1.21	2
TRUNP200	819262	200	2.38	2
TRUNP300	819263	300	3.76	2

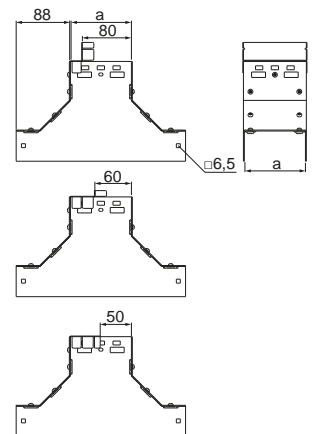

Use:
Branching of cable routes.

Additional information:

- mounting with SGK6x14 bolts
- mounting by placing on the tray from the top or bottom (after cutting out the bottom first)
- the possibility of installing a reduction cover rotated in 90° increments allows you to leave with a cable tray or ladder with a height in the range of 50-100 mm in four positions

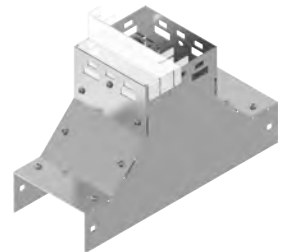



CABLE TRAYS - POWER SUPPLY TO MACHINES H200



Cable Tray	KMZC...H200	mat.: S	option: F, E		
code	catalogue number	dimension a/L [mm]	weight 1 m [kg]	quantity per package [m]	
Material thickness = 2.0 mm					
KMZC200H200/2	819420	200/2000	13.83	4	
KMZC300H200/2	819430	300/2000	16.30	4	
KMZC400H200/2	819440	400/2000	20.50	4	
KMZC500H200/2	819450	500/2000	23.86	4	
KMZC600H200/2	819460	600/2000	27.00	4	

Additional information:
 – trays with hinges and covers included

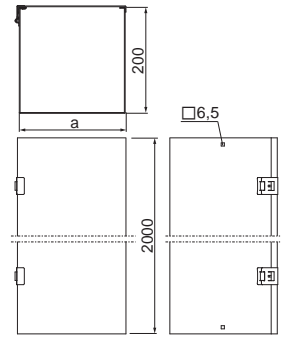

Cable Tray	KMPC...H200	mat.: S	option: F, E		
code	catalogue number	dimension a/L [mm]	weight 1 m [kg]	quantity per package [m]	
Material thickness = 2.0 mm					
KMPC200H200/2	816620	200/2000	13.83	4	
KMPC300H200/2	816630	300/2000	16.30	4	
KMPC400H200/2	816640	400/2000	20.50	4	
KMPC500H200/2	816650	500/2000	23.86	4	
KMPC600H200/2	816660	600/2000	27.00	4	

Use:
 Routing machine power supply cable routes.

Additional information:
 – trays with locking covers included

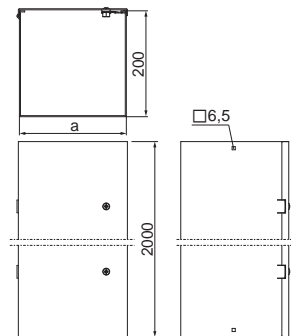

Cable Tray		KMP...H200	mat.: S	option: F, E	
code	catalogue number	dimension a/L [mm]	weight 1 m [kg]	quantity per package [m]	
Material thickness = 1.5 mm					
KMP200H200/2	816720	200/2000	7.66	4	
KMP300H200/2	816730	300/2000	8.89	4	
KMP400H200/2	816740	400/2000	10.13	4	
KMP500H200/2	816750	500/2000	11.37	4	
KMP600H200/2	816760	600/2000	12.60	4	

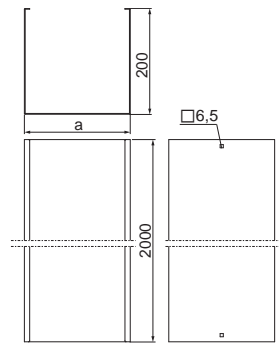

Cable Tray		KMC...H200	mat.: S	option: F, E	
code	catalogue number	dimension a/L [mm]	weight 1 m [kg]	quantity per package [m]	
Material thickness = 2.0 mm					
KMC200H200/2	816820	200/2000	10.21	4	
KMC300H200/2	816830	300/2000	11.04	4	
KMC400H200/2	816840	400/2000	13.51	4	
KMC500H200/2	816850	500/2000	15.16	4	
KMC600H200/2	816860	600/2000	16.80	4	



Use:
Routing machine power supply cable routes.

Additional information:
– on request it is possible to make trays of 3 m in length

Cable Tray Connector		LKMC...H200	mat.: S	option: F, E	
code	catalogue number	dimension a [mm]	weight 1 pc. [kg]	quantity per package [pcs.]	
Material thickness = 2.0 mm					
LKMC200H200	816920	195	0.93	2	
LKMC300H200	816930	295	1.06	2	
LKMC400H200	816940	395	1.22	2	
LKMC500H200	816950	495	1.40	2	
LKMC600H200	816960	595	1.51	2	

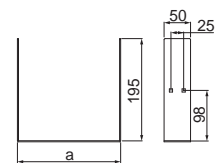

Use:
Connecting trays and fittings.

Additional information:
– use SGK6x14 bolts for mounting with trays

Fastening Clamp		SMKMC200	mat.: S	option: FP, E	
code	catalogue number	weight 1 pc. [kg]	quantity per package [pcs.]		
Material thickness = 2.0 mm					
SMKMC200	810003	0.11	10		

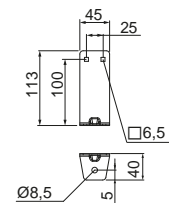

Use:
Mounting trays to the substrate.

Additional information:
– use SGK6x14 bolts for mounting with trays



Horizontal Bend 90°

KKMC...H200

mat.: S

option: F, E

code	catalogue number	dimension a [mm]	weight 1 pc. [kg]	quantity per package [pcs.]
Material thickness = 2.0 mm				
KKMC200H200	817020	200	3.95	2
KKMC300H200	817030	300	6.53	2
KKMC400H200	817040	400	9.74	2
KKMC500H200	817050	500	13.58	2
KKMC600H200	817060	600	18.06	2

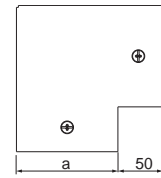

Horizontal Bend 45°

KKMMC...H200

mat.: S

option: F, E

code	catalogue number	dimension a [mm]	weight 1 pc. [kg]	quantity per package [pcs.]
Material thickness = 2.0 mm				
KKMMC200H200	817120	200	2.41	2
KKMMC300H200	817130	300	3.67	2
KKMMC400H200	817140	400	5.19	2
KKMMC500H200	817150	500	6.97	2
KKMMC600H200	817160	600	9.02	2

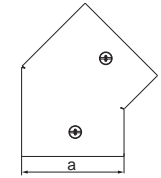

Use:

Changing the direction of the cable route.

Additional information:

- for the mounting fittings, use LKM connectors... and SGKM6x14 bolts
- fitting covers included

Horizontal Tee

TKMC...H200

mat.: S

option: F, E

code	catalogue number	dimension a [mm]	weight 1 pc. [kg]	quantity per package [pcs.]
Material thickness = 2.0 mm				
TKMC200H200	817220	200	3.94	2
TKMC300H200	817230	300	6.33	2
TKMC400H200	817240	400	9.36	2
TKMC500H200	817250	500	13.02	2
TKMC600H200	817260	600	17.31	2

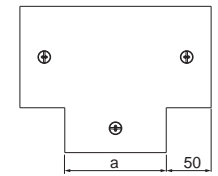

Use:

Branching of cable routes.

Additional information:

- for the mounting fittings, use LKM connectors... and SGKM6x14 bolts
- fitting covers included

Horizontal Cross-over

CZKMC...H200

mat.: S

option: F, E

code	catalogue number	dimension a [mm]	weight 1 pc. [kg]	quantity per package [pcs.]
Material thickness = 2.0 mm				
CZKMC200H200	817320	200	4.13	2
CZKMC300H200	817330	300	6.43	2
CZKMC400H200	817340	400	9.52	2
CZKMC500H200	817350	500	13.53	2
CZKMC600H200	817360	600	18.43	2

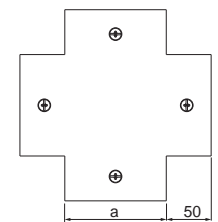

Use:

Branching of cable routes.

Additional information:

- for the mounting fittings, use LKM connectors... and SGKM6x14 bolts
- fitting covers included

Angle Reducer

RKKMP...H200

mat.: S

option: F, E

code	catalogue number	dimension a [mm]	weight 1 pc. [kg]	quantity per package [pcs.]
Material thickness = 1.5 mm				
RKKMP100H200	817610	100	0.44	2
RKKMP200H200	817620	200	0.75	2

Additional information:

- universal element
- possibility to form left and right reducer

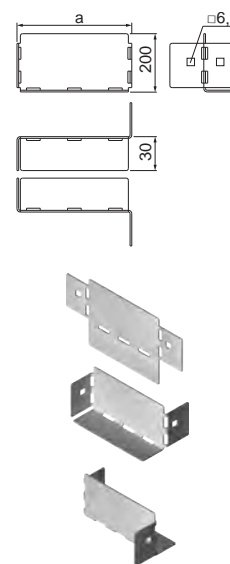

Straight Reducer

RSKMC...H200

mat.: S

option: F, E

code	catalogue number	dimension a/b [mm]	weight 1 pc. [kg]	quantity per package [pcs.]
Material thickness = 2.0 mm				
RSKMC300/200H200	817420	300/200	2.41	2
RSKMC400/300H200	817430	400/300	2.88	2
RSKMC500/400H200	817440	500/400	3.36	2
RSKMC600/500H200	817450	600/500	3.83	2

Use:

Changing the width of the cable route.

Additional information:

- for the mounting fittings, use LKM connectors... and SGK6x14 bolts
- fitting covers included

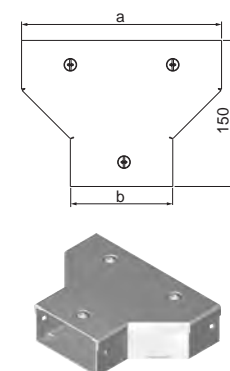

Horizontal Bypass

OPZKMC...H200 mat.: S option: F, E

code	catalogue number	dimension a [mm]	weight 1 pc. [kg]	quantity per package [pcs.]
Material thickness = 2.0 mm				
OPZKMC200H200	817720	200	4.73	2
OPZKMC300H200	817730	300	5.81	2
OPZKMC400H200	817740	400	6.90	2
OPZKMC500H200	817750	500	7.98	2
OPZKMC600H200	817760	600	9.06	2

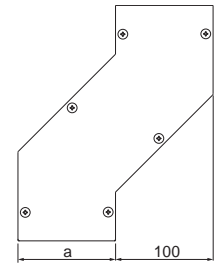

Vertical Bypass

OPNKMC...H200 mat.: S option: F, E

code	catalogue number	dimension a [mm]	weight 1 pc. [kg]	quantity per package [pcs.]
Material thickness = 2.0 mm				
OPNKMC200H200	817820	200	4.93	2
OPNKMC300H200	817830	300	6.14	2
OPNKMC400H200	817840	400	7.35	2
OPNKMC500H200	817850	500	8.56	2
OPNKMC600H200	817860	600	9.77	2

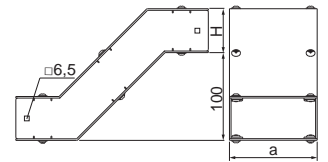

Use:

Bypassing an obstacle along the cable route.

Additional information:

- for the mounting fittings, use LKM connectors... and SGKM6x14 bolts
- fitting covers included

90° Vertical Bend

LPKMC...H200

mat.: S

option: F, E

code	catalogue number	dimension a [mm]	weight 1 pc. [kg]	quantity per package [pcs.]
------	------------------	------------------	-------------------	-----------------------------



Material thickness = 2.0 mm

LPKMC200H200	817920	200	3.86	2
LPKMC300H200	817930	300	4.91	2
LPKMC400H200	817940	400	5.96	2
LPKMC500H200	817950	500	7.02	2
LPKMC600H200	817960	600	8.07	2

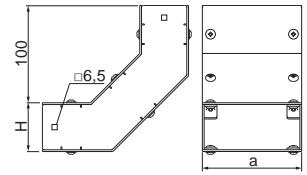

45° Vertical Bend

LPKMMC...H200

mat.: S

option: F, E

code	catalogue number	dimension a [mm]	weight 1 pc. [kg]	quantity per package [pcs.]
------	------------------	------------------	-------------------	-----------------------------



Material thickness = 2.0 mm

LPKMMC200H200	818020	200	2.37	2
LPKMMC300H200	818030	300	3.01	2
LPKMMC400H200	818040	400	3.65	2
LPKMMC500H200	818050	500	4.28	2
LPKMMC600H200	818060	600	4.92	2

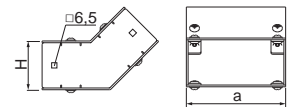

Use:

Changing the direction of the cable route.

Additional information:

- for the mounting fittings, use LKM connectors... and SGKM6x14 bolts
- fitting covers included



CABLE TRAYS - POWER SUPPLY TO MACHINES H200



Elbow - Right

KRPKMC...H200 mat.: S option: F, E

code	catalogue number	dimension a [mm]	weight 1 pc. [kg]	quantity per package [pcs.]
Material thickness = 2.0 mm				
KRPKMC200H200	818120	200	5.01	2
KRPKMC300H200	818130	300	7.77	2
KRPKMC400H200	818140	400	11.07	2
KRPKMC500H200	818150	500	14.96	2
KRPKMC600H200	818160	600	19.43	2

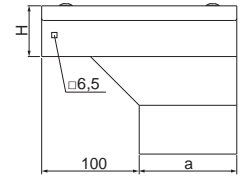

Elbow - Left

KRLKMC...H200 mat.: S option: F, E

code	catalogue number	dimension a [mm]	weight 1 pc. [kg]	quantity per package [pcs.]
Material thickness = 2.0 mm				
KRLKMC200H200	818220	200	5.01	2
KRLKMC300H200	818230	300	7.77	2
KRLKMC400H200	818240	400	11.07	2
KRLKMC500H200	818250	500	14.96	2
KRLKMC600H200	818260	600	19.43	2

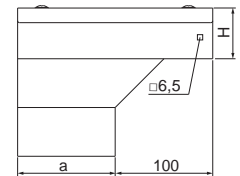

Use:

Changing the direction of the cable route.

Bottom Elbow - Right KRPDMC...H200 mat.: S option: F, E

code	catalogue number	dimension a [mm]	weight 1 pc. [kg]	quantity per package [pcs.]
Material thickness = 2.0 mm				
KRPDMC200H200	819020	200	5.01	2
KRPDMC300H200	819030	300	8.30	2
KRPDMC400H200	819040	400	12.07	2
KRPDMC500H200	819050	500	16.21	2
KRPDMC600H200	819060	600	20.60	2

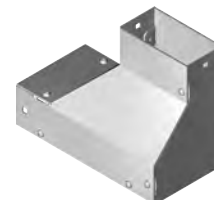
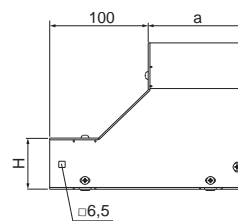

Bottom Elbow - Left KRLDMC...H200 mat.: S option: F, E

code	catalogue number	dimension a [mm]	weight 1 pc. [kg]	quantity per package [pcs.]
Material thickness = 2.0 mm				
KRLDMC200H200	819120	200	5.01	2
KRLDMC300H200	819130	300	8.30	2
KRLDMC400H200	819140	400	12.07	2
KRLDMC500H200	819150	500	16.21	2
KRLDMC600H200	819160	600	20.60	2

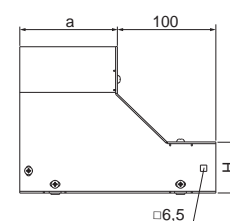

Use:

Changing the direction of the cable route.

Additional information:

- for the mounting fittings, use LKM connectors... and SGK6x14 bolts
- fitting covers included



CABLE TRAYS - POWER SUPPLY TO MACHINES H200



Reduction tee

TRKMC...H200

mat.: S

option: F, E

code	catalogue number	dimension a [mm]	weight 1 pc. [kg]	quantity per package [pcs.]
Material thickness = 2.0 mm				
TRKMC200H200	818320	200	5.60	2
TRKMC300H200	818330	300	8.64	2
TRKMC400H200	818340	400	12.47	2
TRKMC500H200	818350	500	17.11	2
TRKMC600H200	818360	600	22.55	2

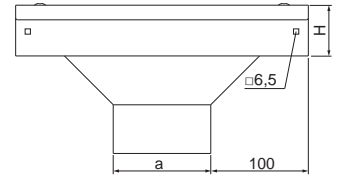

Use:

Branching of cable routes.

Additional information:

- for the mounting fittings, use LKM connectors... and SGKM6x14 bolts
- fitting covers included

Add-on Tee

TDKMC...H200

mat.: S

option: F, E

code	catalogue number	dimension a [mm]	weight 1 pc. [kg]	quantity per package [pcs.]
Material thickness = 2.0 mm				
TDKMC200H200	817520	200	1.62	2
TDKMC300H200	817530	300	1.95	2
TDKMC400H200	817540	400	2.28	2
TDKMC500H200	817550	500	2.60	2
TDKMC600H200	817560	600	2.93	2

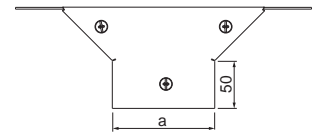

Use:

Branching of cable routes.

Additional information:

- mounting with SGKM6x14 bolts
- fitting covers included

Bottom Tee - Lengthwise

TRSDMC...H200

mat.: S

option: F, E

code	catalogue number	dimension a [mm]	weight 1 pc. [kg]	quantity per package [pcs.]
Material thickness = 2.0 mm				
TRSDMC200H200	819220	200	5.09	2
TRSDMC300H200	819230	300	6.24	2
TRSDMC400H200	819240	400	7.41	2
TRSDMC500H200	819250	500	8.57	2
TRSDMC600H200	819260	600	9.74	2

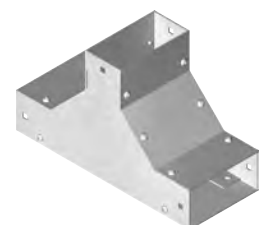
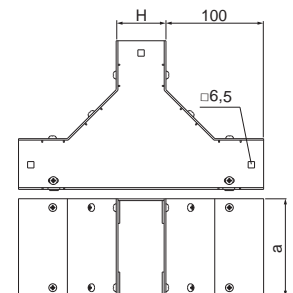

Use:

Branching of cable routes.

Additional information:

- for the mounting fittings, use LKM connectors... and SGKM6x14 bolts

Cover	PKMP...	mat.: S	option: F, E	
code	catalogue number	dimension a/L [mm]	weight 1 m [kg]	quantity per package [m]
Material thickness = 1.5 mm				
PKMP50/2	830005	50/2000	0.86	20
PKMP100/2	830010	100/2000	1.48	12
PKMP200/2	830020	200/2000	2.71	8
PKMP300/2	830030	300/2000	3.95	8
PKMP400/2	830040	400/2000	5.19	4
PKMP500/2	830050	500/2000	6.42	4
PKMP600/2	830060	600/2000	7.66	4

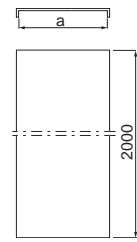

Cover	PKMC...	mat.: S	option: F, E	
code	catalogue number	dimension a/L [mm]	weight 1 m [kg]	quantity per package [m]
Material thickness = 2.0 mm				
PKMC50/2	830105	50/2000	1.15	20
PKMC100/2	830110	100/2000	1.97	12
PKMC200/2	830120	200/2000	3.62	8
PKMC300/2	830130	300/2000	5.27	8
PKMC400/2	830140	400/2000	6.92	4
PKMC500/2	830150	500/2000	8.56	4
PKMC600/2	830160	600/2000	10.21	4

Use:
Protects cables from damage, UV rays and weather conditions. Airtight protection against the accumulation of dust and dirt.

Cover Clamp	ZAP...	mat.: S	option: FP, E	
code	catalogue number	dimension H [mm]	weight 1 pc. [kg]	quantity per package [pcs.]
Material thickness = 1.5 mm				
ZAP50	830001	41	0.01	10
ZAP100	830002	71	0.02	10
ZAP200	830003	121	0.04	10

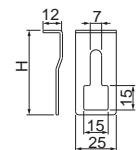

Use:
Mounting covers.
Additional information:
– mounting covers for machine power supply trays

Cover hinge	ZPR...	mat.: G	option: FP, E	
code	catalogue number	weight 1 pc. [kg]	quantity per package [pcs.]	
Material thickness = 1.5 mm				
ZPR1	831015	0.02	10	
ZPR2	831020	0.02	10	

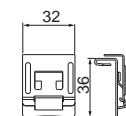

Use:
Allows quick hinged of the tray cover.
Additional information:
– ZPR1 fits trays with a thickness of 1.5 mm.
– ZPR2 fits trays with a thickness of 2.0 mm.
– quick and easy mounting without tools
– possibility of installing anywhere on the side of the tray

Covers support

PPKM...

mat.: S

option: F, E

code	catalogue number	dimension a/H [mm]	weight 1 pc. [kg]	quantity per package [pcs.]
Material thickness = 2.0 mm				
PPKM200H50	830520	200/50	0.15	2
PPKM300H50	830530	300/50	0.23	2
PPKM400H50	830540	400/50	0.32	2
PPKM500H50	830550	500/50	0.39	2
PPKM600H50	830560	600/50	0.48	2
PPKM200H100	831520	200/100	0.15	2
PPKM300H100	831530	300/100	0.23	2
PPKM400H100	831540	400/100	0.32	2
PPKM500H100	831550	500/100	0.39	2
PPKM600H100	831560	600/100	0.48	2
PPKM200H200	832520	200/200	0.21	2
PPKM300H200	832530	300/200	0.23	2
PPKM400H200	832540	400/200	0.32	2
PPKM500H200	832550	500/200	0.39	2
PPKM600H200	832560	600/200	0.48	2

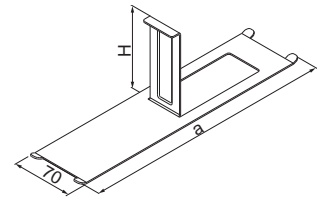

Use:

Internal cover protection against bending when walking on the trays.

Additional information:

- allows safe walking on trays to power machines, minimizes deformation of the cover. Use every 0.5 m

Cable Clip

UDF...

mat.: G

option: FP, L

code	catalogue number	dimension D [mm]	quantity per package [pcs.]
Material thickness = 1.2 mm			
UDF5	405505	5	100
UDF6	405506	6	100
UDF7	405507	7	100
UDF8	405508	8	100
UDF9	405509	9	100
UDF10	405510	10	100
UDF12	405512	12	100
UDF14	405514	14	100
Material thickness = 2.0 mm			
UDF15	405515	15	100
UDF16	405516	16	100
UDF18	405518	18	100
UDF20	405520	20	100
UDF22	405522	22	100
UDF25	405525	25	100
UDF26	405526	26	100
UDF28	405528	28	100
UDF32	405532	32	100
UDF33	405533	33	100
UDF35	405535	35	100
UDF36	405536	36	100
UDF40	405540	40	100
UDF42	405542	42	100

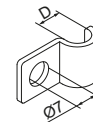

Use:

Direct fixing of cables to walls and ceilings.

Cable Clip	UDF...E	mat.: E		
code	catalogue number	dimension D [mm]	quantity per package [pcs.]	
Material thickness = 1.2 mm				
UDF5E	415505	5	100	
UDF6E	415506	6	100	
UDF7E	415507	7	100	
UDF8E	415508	8	100	
UDF9E	415509	9	100	
UDF10E	415510	10	100	
UDF12E	415512	12	100	
UDF14E	415514	14	100	
Material thickness = 2.0 mm				
UDF15E	415515	15	100	
UDF16E	415516	16	100	
UDF18E	415518	18	100	
UDF20E	415520	20	100	
UDF22E	415522	22	100	
UDF25E	415525	25	100	
UDF26E	415526	26	100	
UDF28E	415528	28	100	
UDF32E	415532	32	100	
UDF33E	415533	33	100	
UDF35E	415535	35	100	
UDF36E	415536	36	100	
UDF40E	415540	40	100	
UDF42E	415542	42	100	

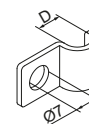

Cable Clip	UEF...	mat.: G	option: FP, L	
code	catalogue number	dimension D [mm]	quantity per package [pcs.]	
Material thickness = 1.2 mm				
UEF5	405605	5	100	
UEF6	405606	6	100	
UEF7	405607	7	100	
UEF8	405608	8	100	
UEF9	405609	9	100	
UEF10	405610	10	100	
UEF12	405612	12	100	
UEF14	405614	14	100	
Material thickness = 2.0 mm				
UEF15	405615	15	100	
UEF16	405616	16	100	
UEF18	405618	18	100	
UEF20	405620	20	100	
UEF22	405622	22	100	
UEF25	405625	25	100	
UEF26	405626	26	100	
UEF28	405628	28	100	
UEF32	405632	32	100	
UEF33	405633	33	100	
UEF35	405635	35	100	
UEF36	405636	36	100	
UEF40	405640	40	100	
UEF42	405642	42	100	

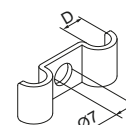

Use:
Direct fixing of cables to walls and ceilings.

Cable Clip	UEF...E	mat.: E		
code	catalogue number	dimension D [mm]	quantity per package [pcs.]	
Material thickness = 1.2 mm				
UEF5E	415605	5	100	
UEF6E	415606	6	100	
UEF7E	415607	7	100	
UEF8E	415608	8	100	
UEF9E	415609	9	100	
UEF10E	415610	10	100	
UEF12E	415612	12	100	
UEF14E	415614	14	100	
Material thickness = 2.0 mm				
UEF15E	415615	15	100	
UEF16E	415616	16	100	
UEF18E	415618	18	100	
UEF20E	415620	20	100	
UEF22E	415622	22	100	
UEF25E	415625	25	100	
UEF26E	415626	26	100	
UEF28E	415628	28	100	
UEF32E	415632	32	100	
UEF33E	415633	33	100	
UEF35E	415635	35	100	
UEF36E	415636	36	100	
UEF40E	415640	40	100	
UEF42E	415642	42	100	

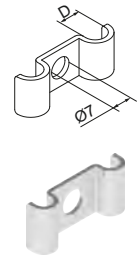

Use:
Direct fixing of cables to walls and ceilings.

Tray mounting insert for vertical cable installation WMKM...H50		mat.: S		
code	catalogue number	dimension a/H [mm]	weight 1 pc. [kg]	quantity per package [pcs.]
Material thickness = 1.0 mm				
WMKM100H50	819266	96/46	0.80	1
WMKM200H50	819267	195/45	1.60	1
WMKM300H50	819268	295/45	2.40	1

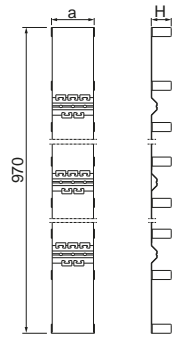

Tray mounting insert for vertical cable installation WMKM...H100		mat.: S		
code	catalogue number	dimension a/H [mm]	weight 1 pc. [kg]	quantity per package [pcs.]
Material thickness = 1.0 mm				
WMKM100H100	819269	96/96	0.90	1
WMKM200H100	819270	195/95	1.70	1
WMKM300H100	819271	295/95	2.50	1



Use:
Mounting cables in a vertically guided tray using cable clamps or cable ties.

Additional information:
– the largest cable clamps that can be used in the tray are the UKZ1/UKZO1/28-34 and UKZP1/28-34

Cable Clamp		UKZ1/UKZO1...	mat.: FP	option: E	
code	catalogue number	dimension D _{min} /D _{max} /H [mm]	weight 1 pc. [kg]	quantity per package [pcs.]	
UKZ1/UKZO1/8-12	400980	8/12/42	0.03	100	
UKZ1/UKZO1/12-16	400990	12/16/46	0.03	100	
UKZ1/UKZO1/16-22	400900	16/22/62	0.04	100	
UKZ1/UKZO1/22-28	401000	22/28/69	0.06	100	
UKZ1/UKZO1/28-34	401100	28/34/76	0.07	100	
UKZ1/UKZO1/34-40	401200	34/40/82	0.08	100	
UKZ1/UKZO1/40-46	401300	40/46/91	0.09	100	
UKZ1/UKZO1/46-52	401400	46/52/102	0.10	100	
UKZ1/UKZO1/52-58	401601	52/58/107	0.11	100	
UKZ1/UKZO1/58-64	401500	58/64/111	0.12	100	
UKZ1/UKZO1/64-70	401501	64/70/117	0.13	100	

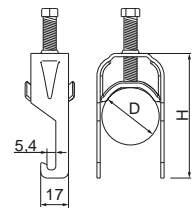

Additional information:

- RO1 protective trays are recommended

Cable Clamp with plastic scales		UKZP1...	mat.: FP	option: E	
code	catalogue number	dimension D _{min} /D _{max} /H [mm]	weight 1 pc. [kg]	quantity per package [pcs.]	
UKZP1/8-12	425865	8/12/42	0.03	150	
UKZP1/12-16	425866	12/16/46	0.03	150	
UKZP1/16-22	425867	16/22/62	0.04	150	
UKZP1/22-28	425868	22/28/69	0.06	150	
UKZP1/28-34	425869	28/34/76	0.07	100	
UKZP1/34-40	425870	34/40/82	0.08	100	
UKZP1/40-46	425871	40/46/91	0.09	100	
UKZP1/46-52	425872	46/52/102	0.10	100	
UKZP1/52-58	425873	52/58/107	0.11	100	
UKZP1/58-64	425874	58/64/111	0.12	100	
UKZP1/64-70	425875	58/64/117	0.13	100	

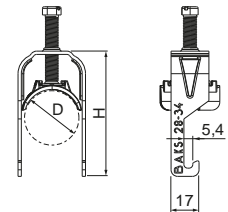

Use:

Cable mounting for DK... ladders, KDS..., KSG..., KCS... mesh trays and KSP..., KSC..., KST... self-supporting trays, as well as CMS...41H21 channels

Additional information:

- bracket shell is made of polyethylene
- RO1 protective trays are recommended
- SUKP... cable separators are recommended

