



ADVANTAGES OF THE VERTICAL LADDER SYSTEM

The system includes ladders made of channel sections with a wall thickness of 3 mm or I80 I-beams - a typical application is to run the route in vertical orientation in places where there is no possibility of additional fixing of the route between the bottom and top points of the route.

1. Strength parameters confirmed by empirical tests
2. Possibility to order a system based on the I100 I-beam - even greater mechanical strength compared to the standard system
3. It is possible to manufacture elements in different coatings and materials: hot-dip galvanised steel according to PN-EN ISO 1461:2023-02 (up to 100 µm), powder-coated galvanised steel, stainless steel 1.4301, 1.4044, 1.4571 (AISI grades: 304, 304L, 316, 316L, 316Ti and others), thanks to such a wide range of materials and coatings, there is a very high possibility of application in any environment
4. Two ways to install rungs in ladders:
 - single-sided, all rungs mounted on the same side allow cables to be routed from only one side of the ladder
 - double-sided, rungs mounted alternately on both sides allow cables to be routed on both sides of the ladder
5. All the necessary certificates and approvals for the vertical ladder system:
 - TÜV Rheinland certification for mechanical strength in accordance with the PN-EN 61537 standard
 - VDE certification for electrical continuity in accordance with the PN-EN 61537 standard
 - TÜV Rheinland certification confirming compliance of the production quality management system with the ISO 9001:2008 standard
 - TÜV Rheinland certification confirming compliance of the production quality management system with the ISO 14001:2008 standard
 - EC Declaration of Conformity
6. Technology and production quality at the highest level globally, thanks to the use of machinery from the best manufacturers on the market.
7. Design and production of unusual, non-standard elements - any length, width, height, type of material and use of any paint colour do not limit the possibilities in creating aesthetically pleasing and innovative solutions. We are flexible and open to customer needs.
8. All production located in one place and our own hot-dip galvanising plant, flake galvanising plant and powder coating plant - this allows us to fully control the entire production process, maintain the highest quality of the product and reduce lead times.
9. We produce from high quality materials, sheet metal, manufactured in Western European steel mills (Arcelor Mittal Eisenhüttenstadt, Arcelor Mittal Bremen, Arcelor Mittal Liege, Arcelor Mittal Gent) - high quality materials guarantee trouble-free and fast installation, long service life, uniform appearance of all products as well as conformity with safety standards in accordance with obtained certificates.



Cable ladder - Vertical system H55



Vertical Cable Ladder	DMC...H55	mat.: S	option: F, E, L		
code	catalogue number	dimension a/L [mm]	weight 1 m [kg]	quantity per package [m]	
Material thickness = 2.0 mm					
DMC200H55/3	404820	200/3000	4.56	3	
DMC200H55/6	404920	200/6000	4.56	6	
DMC300H55/3	404830	300/3000	4.82	3	
DMC300H55/6	404930	300/6000	4.82	6	
DMC400H55/3	404840	400/3000	5.08	3	
DMC400H55/6	404940	400/6000	5.08	6	
DMC500H55/3	404850	500/3000	5.34	3	
DMC500H55/6	404950	500/6000	5.34	6	
DMC600H55/3	404860	600/3000	5.60	3	
DMC600H55/6	404960	600/6000	5.60	6	
DMC700H55/3	404870	700/3000	5.90	3	
DMC700H55/6	404970	700/6000	5.90	6	
DMC800H55/3	404880	800/3000	6.18	3	
DMC800H55/6	404980	800/6000	6.18	6	
DMC900H55/3	404890	900/3000	6.44	3	
DMC900H55/6	404990	900/6000	6.44	6	
DMC1000H55/3	404900	1000/3000	6.72	3	
DMC1000H55/6	404991	1000/6000	6.72	6	

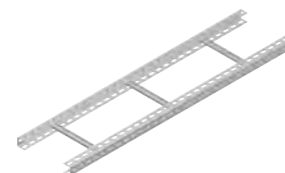
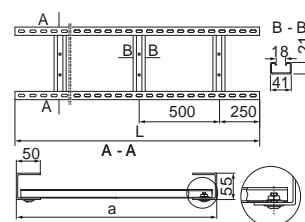

Vertical Cable Ladder	DM...H55	mat.: S	option: F, E, L		
code	catalogue number	dimension a/L [mm]	weight 1 m [kg]	quantity per package [m]	
Material thickness = 3.0 mm					
DM200H55/3	404620	200/3000	6.10	3	
DM200H55/6	404720	200/6000	6.10	6	
DM300H55/3	404630	300/3000	6.36	3	
DM300H55/6	404730	300/6000	6.36	6	
DM400H55/3	404640	400/3000	6.62	3	
DM400H55/6	404740	400/6000	6.62	6	
DM500H55/3	404650	500/3000	6.88	3	
DM500H55/6	404750	500/6000	6.88	6	
DM600H55/3	404660	600/3000	7.14	3	
DM600H55/6	404760	600/6000	7.14	6	
DM700H55/3	404670	700/3000	7.44	3	
DM700H55/6	404770	700/6000	7.44	6	
DM800H55/3	404680	800/3000	7.72	3	
DM800H55/6	404780	800/6000	7.72	6	
DM900H55/3	404690	900/3000	7.98	3	
DM900H55/6	404790	900/6000	7.98	6	
DM1000H55/3	404611	1000/3000	8.26	3	
DM1000H55/6	404800	1000/6000	8.26	6	

Use:

Routing vertical cable routes of various types.

Additional information:

- the use of a new rung with increased strength parameters stiffens the ladder
- the possibility of mounting cables in UKZ/UKZO... and UK/UKO... and UKZP... and UKP... clamps
- special bolts (with a flattened head) for mounting the rungs allow direct mounting ladder to the wall
- option E – only for sections up to 3 m



Vertical Cable Ladder		DDMC...H55	mat.: S	option: F, E, L	
code	catalogue number	dimension a/L [mm]	weight 1 m [kg]	quantity per package [m]	
Material thickness = 2.0 mm					
DDMC200H55/3	403320	200/3000	5.08	3	
DDMC200H55/6	403420	200/6000	5.08	6	
DDMC300H55/3	403330	300/3000	5.60	3	
DDMC300H55/6	403430	300/6000	5.60	6	
DDMC400H55/3	403340	400/3000	6.12	3	
DDMC400H55/6	403440	400/6000	6.12	6	
DDMC500H55/3	403350	500/3000	6.64	3	
DDMC500H55/6	403450	500/6000	6.64	6	
DDMC600H55/3	403360	600/3000	7.16	3	
DDMC600H55/6	403460	600/6000	7.16	6	
DDMC700H55/3	403370	700/3000	7.76	3	
DDMC700H55/6	403470	700/6000	7.76	6	
DDMC800H55/3	403380	800/3000	8.32	3	
DDMC800H55/6	403480	800/6000	8.32	6	
DDMC900H55/3	403390	900/3000	8.84	3	
DDMC900H55/6	403490	900/6000	8.84	6	
DDMC1000H55/3	403391	1000/3000	9.40	3	
DDMC1000H55/6	403491	1000/6000	9.40	6	

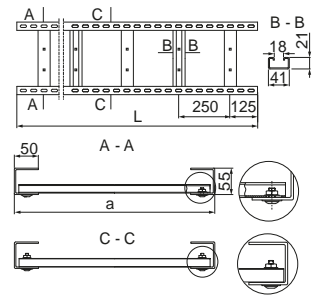

Vertical Cable Ladder		DDM...H55	mat.: S	option: F, E, L	
code	catalogue number	dimension a/L [mm]	weight 1 m [kg]	quantity per package [m]	
Material thickness = 3.0 mm					
DDM200H55/3	403520	200/3000	6.62	3	
DDM200H55/6	403620	200/6000	6.62	6	
DDM300H55/3	403530	300/3000	7.14	3	
DDM300H55/6	403630	300/6000	7.14	6	
DDM400H55/3	403540	400/3000	7.66	3	
DDM400H55/6	403640	400/6000	7.66	6	
DDM500H55/3	403550	500/3000	8.18	3	
DDM500H55/6	403650	500/6000	8.18	6	
DDM600H55/3	403560	600/3000	8.70	3	
DDM600H55/6	403660	600/6000	8.70	6	
DDM700H55/3	403570	700/3000	9.30	3	
DDM700H55/6	403670	700/6000	9.30	6	
DDM800H55/3	403580	800/3000	9.86	3	
DDM800H55/6	403680	800/6000	9.86	6	
DDM900H55/3	403590	900/3000	10.38	3	
DDM900H55/6	403690	900/6000	10.38	6	
DDM1000H55/3	403591	1000/3000	10.94	3	
DDM1000H55/6	403691	1000/6000	10.94	6	

Use:

Routing vertical cable routes of various types.

Additional information:

- the use of a new rung with increased strength parameters stiffens the ladder
- ladders with rungs mounted on both sides.
- the possibility of mounting cables in UKZ/UKZO... and UK/UKO... and UKZP... and UKP... clamps on both sides of the ladder
- option E – only for sections up to 3 m

Cable ladder - Vertical system H55



Channel	CC55H50...	mat.: S	option: F, E, L	
code	catalogue number	dimension L [mm]	weight 1 pc. [kg]	quantity per package [pcs.]
Material thickness = 2.0 mm				
CC55H50/03	612103	300	0.60	20
CC55H50/04	612104	400	0.81	20
CC55H50/05	612105	500	1.01	20
CC55H50/1	612110	1000	2.02	8
CC55H50/2	612120	2000	4.05	8
CC55H50/3	612130	3000	6.09	4

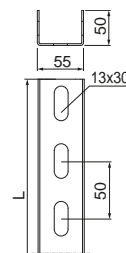

Channel	CT55H50...	mat.: S	option: F, E, L	
code	catalogue number	dimension L [mm]	weight 1 pc. [kg]	quantity per package [pcs.]
Material thickness = 3.0 mm				
CT55H50/2	612220	2000	5.58	8
CT55H50/3	612230	3000	8.37	4
CT55H50/6	612260	6000	16.74	2

Use:

For hanging lamps and as a structural element for mounting ladders and cable trays. As a support element for wall brackets: WWSR..., WW..., WWS/WWSO..., WU/WUO..., WWSN..., WSZN... (for th. ≥ 2 mm), WPL..., WPT..., WMCN..., WMC/WMCO...

Additional information:

- for self-mounting vertical ladders
- use SGKM10x16 or SGM10x16 bolts to join the channel with the connector
- option E for sections up to 3 m

Connector	LC55H50	mat.: S	option: F, E, L	
code	catalogue number	weight 1 pc. [kg]	quantity per package [pcs.]	
Material thickness = 3.0 mm				
LC55H50	660700	0.48	30	

Use:

Connecting channels.

Additional information:

- use 8 sets of SGKM10x16 or SGM10x16 bolts for mounting

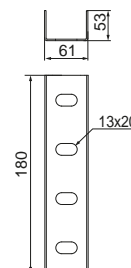

Protective cap	NO55x50N	mat.: PE	quantity per package [pcs.]	
code	catalogue number			
NO55x50N	760610	100		



Use:

Protection of the fitter from injury from steel edges, improving visual aspect.



Cable Ladder		DUVD...H60	mat.: S	option: F, E, L	
code	catalogue number	dimension a/L [mm]	weight 1 m [kg]	quantity per package [m]	
Material thickness = 1.2 mm					
DUVD100H60/3	466013	100/3000	2.01	3	
DUVD100H60/6	466016	100/6000	2.01	6	
DUVD200H60/3	466023	200/3000	2.24	3	
DUVD200H60/6	466026	200/6000	2.24	6	
DUVD300H60/3	466033	300/3000	2.47	3	
DUVD300H60/6	466036	300/6000	2.47	6	
DUVD400H60/3	466043	400/3000	2.81	3	
DUVD400H60/6	466046	400/6000	2.81	6	
DUVD500H60/3	466053	500/3000	2.92	3	
DUVD500H60/6	466056	500/6000	2.92	6	
DUVD600H60/3	466063	600/3000	3.15	3	
DUVD600H60/6	466066	600/6000	3.15	6	

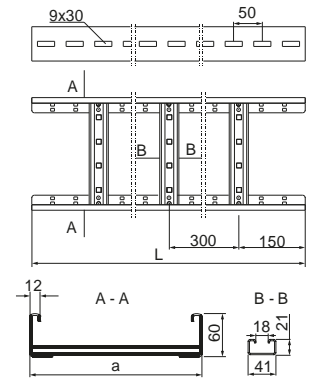

Cable Ladder		DUVC...H60	mat.: S	option: F, E, L	
code	catalogue number	dimension a/L [mm]	weight 1 m [kg]	quantity per package [m]	
Material thickness = 2.0 mm					
DUVC100H60/3	466611	100/3000	3.22	12	
DUVC100H60/6	466711	100/6000	3.22	12	
DUVC200H60/3	466621	200/3000	3.58	12	
DUVC200H60/6	466721	200/6000	3.58	12	
DUVC300H60/3	466631	300/3000	3.96	6	
DUVC300H60/6	466731	300/6000	3.96	12	
DUVC400H60/3	466641	400/3000	4.50	6	
DUVC400H60/6	466741	400/6000	4.50	12	
DUVC500H60/3	466651	500/3000	4.67	6	
DUVC500H60/6	466751	500/6000	4.67	12	
DUVC600H60/3	466661	600/3000	5.05	6	
DUVC600H60/6	466761	600/6000	5.05	12	



Use:

Routing vertical cable routes of various types.

Additional information:

- the use of a new rung with increased strength parameters stiffens the ladder
- the possibility of mounting cables in UKZ/UKZO... and UK/UKO... and UKZP... and UKP... clamps
- option E - only for sections up to 3 m - design with less frequent perforation in the bottom of the ladder side

Connector		LDPH60	mat.: S	option: F, E, L	
code	catalogue number	weight 1 pc. [kg]	quantity per package [pcs.]		
Material thickness = 1.5 mm					
LDPH60	441004	0.23	10		

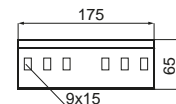

Connector		LDC/LDOCH60N	mat.: S	option: F, E, L	
code	catalogue number	weight 1 pc. [kg]	quantity per package [pcs.]		
Material thickness = 2.0 mm					
LDC/LDOCH60N	461001	0.31	10		



Use:

Connecting cable routes

Additional information:

- use 4 sets of SGKM8x14 or SGM8x14 bolts for mounting

Cable ladder - Vertical system H80



Vertical Cable Ladder	DSH...H80	mat.: F	option: L		
code	catalogue number	dimension a/L [mm]	quantity per package [m]	weight 1 m [kg]	
DSH200H80/3	405020	200/3000	3	12.58	
DSH200H80/6	405120	200/6000	6	12.58	
DSH300H80/3	405030	300/3000	3	12.92	
DSH300H80/6	405130	300/6000	6	12.92	
DSH400H80/3	405040	400/3000	3	13.26	
DSH400H80/6	405140	400/6000	6	13.26	
DSH500H80/3	405050	500/3000	3	13.62	
DSH500H80/6	405150	500/6000	6	13.62	
DSH600H80/3	405060	600/3000	3	13.96	
DSH600H80/6	405160	600/6000	6	13.96	
DSH700H80/3	405070	700/3000	3	14.30	
DSH700H80/6	405170	700/6000	6	14.30	
DSH800H80/3	405080	800/3000	3	14.66	
DSH800H80/6	405180	800/6000	6	14.66	
DSH900H80/3	405090	900/3000	3	15.00	
DSH900H80/6	405190	900/6000	6	15.00	
DSH1000H80/3	405011	1000/3000	3	15.34	
DSH1000H80/6	405111	1000/6000	6	15.34	

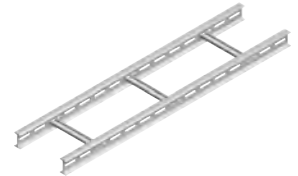
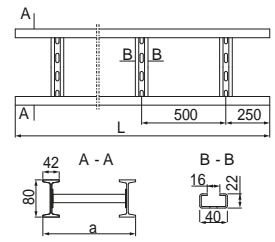

Additional information:

- the possibility of mounting cables in UK/UKO... and UKP... clamps

Vertical Cable Ladder	DDH...H80	mat.: F	option: L		
code	catalogue number	dimension a/L [mm]	weight 1 m [kg]	quantity per package [m]	
DDH200H80/3	404220	200/3000	13.10	3	
DDH200H80/6	404320	200/6000	13.10	6	
DDH300H80/3	404230	300/3000	13.78	3	
DDH300H80/6	404330	300/6000	13.78	6	
DDH400H80/3	404240	400/3000	14.46	3	
DDH400H80/6	404340	400/6000	14.46	6	
DDH500H80/3	404250	500/3000	15.18	3	
DDH500H80/6	404350	500/6000	15.18	6	
DDH600H80/3	404260	600/3000	15.85	3	
DDH600H80/6	404360	600/6000	15.85	6	
DDH700H80/3	404270	700/3000	16.54	3	
DDH700H80/6	404370	700/6000	16.54	6	
DDH800H80/3	404280	800/3000	17.26	3	
DDH800H80/6	404380	800/6000	17.26	6	
DDH900H80/3	404290	900/3000	17.88	3	
DDH900H80/6	404390	900/6000	17.88	6	
DDH1000H80/3	404211	1000/3000	18.60	3	
DDH1000H80/6	404311	1000/6000	18.60	6	

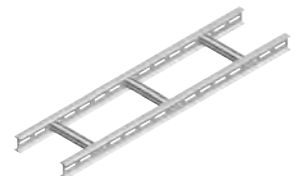
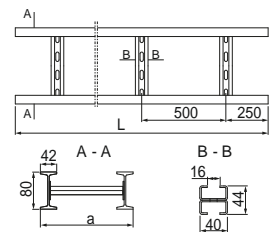

Use:

Routing a vertical and optionally horizontal cable route.

Additional information:

- the possibility of mounting cables in UK/UKO... and UKP... clamps on both sides of the ladder

I-beam	DPH...	mat.: F	option: L		
code	catalogue number	dimension L [mm]	weight 1 pc. [kg]	quantity per package [pcs.]	
DPH200	700220	200	1.14	10	
DPH300	700230	300	1.17	10	
DPH400	700240	400	2.29	8	
DPH500	700250	500	2.85	8	
DPH600	700260	600	3.40	4	
DPH700	700270	700	3.95	2	
DPH800	700280	800	4.55	2	
DPH900	700290	900	5.10	2	
DPH1000	700211	1000	5.70	2	
DPH1500	700216	1500	8.50	2	
DPH2000	700212	2000	11.40	2	
DPH3000	700213	3000	17.10	2	
DPH6000	700217	6000	34.20	1	

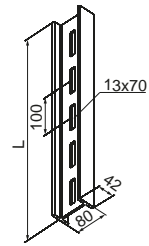

Use:

The basic building block of heavy cable routing systems. Also used for mounting vertical ladders.

I-beam loading table. A - single-sided load, L - length of bracket, Fmax. - maximum load = cable weight + cable tray/cable ladder without the weight of a technician.

A							
L [mm]	100	200	300	400	500	600	
Fmax. [kN]	6,0	5,7	5,4	5,1	4,6	3,9	

A							
L [mm]	100	200	300	400	500	600	
Fmax. [kN]	3,6	3,2	2,7	2,4	2,2	2,0	



Protective cap	NO42x80	mat.: PE	
code	catalogue number	quantity per package [pcs.]	
NO42x80	700221	100	



Use:

Protection of the fitter from injury from steel edges, improving visual aspect.

Rung	SSH...	mat.: F	option: L		
code	catalogue number	dimension L [mm]	weight 1 pc. [kg]	quantity per package [pcs.]	
Material thickness = 2.5 mm					
SSH200	404120	153	0.59	20	
SSH300	404130	253	0.76	20	
SSH400	404140	353	0.93	10	
SSH500	404150	453	1.11	10	
SSH600	404160	553	1.28	10	
SSH700	404170	653	1.45	4	
SSH800	404180	753	1.63	4	
SSH900	404190	853	1.80	4	
SSH1000	404111	953	1.97	4	

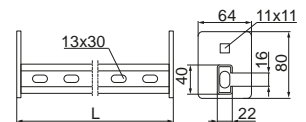

Use:

For self-mounting in DSH ladders... Rungs suitable for mounting UK/UKO... and UKP... clamps for fixing electrical cables.

Additional information:

- mounting - 2 sets of SGFM10x30 bolts

Rung	SDH...	mat.: F	option: L	
code	catalogue number	dimension L [mm]	weight 1 pc. [kg]	quantity per package [pcs.]
Material thickness = 2.5 mm				
SDH200	404420	153	0.85	20
SDH300	404430	253	1.19	20
SDH400	404440	353	1.53	10
SDH500	404450	453	1.89	10
SDH600	404460	553	2.23	10
SDH700	404470	653	2.57	4
SDH800	404480	753	2.93	4
SDH900	404490	853	3.24	4
SDH1000	404411	953	3.60	4

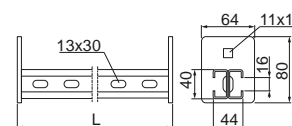

Use:
For self-mounting in DDH ladders... The rung is adapted for double-sided mounting UK/UKO... and UKP... clamps for fixing electrical cables.

Additional information:

- mounting - 2 sets of SGFM10x30 bolts

Fastening Clamp	NKH	mat.: F	option: L	
code	catalogue number	weight 1 pc. [kg]		quantity per package [set]
NKH	700509	0.96		10

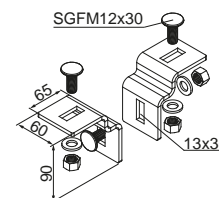

Use:
Used as an element for connecting I-beams.

Additional information:

- Set contains 2 pcs. NKH and 3 SGFM12x30 bolts

Straight Connector	PLH	mat.: F	option: L	
code	catalogue number	weight 1 pc. [kg]		quantity per package [set]
Material thickness = 5.0 mm				
PLH	700420	0.49		10

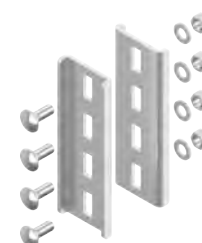
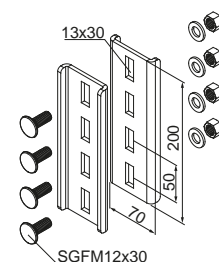

Use:
Used as an element for connecting I-beams.

Additional information:

- Set contains 2 pcs. PLH and 4 SGFM12x30 bolts



Connection Piece	PDHN	mat.: F	option: L	
code	catalogue number	weight 1 pc. [kg]	quantity per package [pcs.]	N

Material thickness = 5.0 mm

PDHN	700321	0.53	10	
------	--------	------	----	--

Use:

Used as an element for connecting I-beams.

Additional information:

- used with PUDHN suspension base
- for mounting, we offer SGFM12x30 bolts

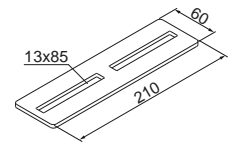

Articulated connector	LGDP	mat.: F	option: L	
code	catalogue number	weight 1 pc. [kg]	quantity per package [pcs.]	

Material thickness = 5.0 mm

LGDP	700422	0.85	10	
------	--------	------	----	--

Use:

Used as an element for connecting I-beams.

Additional information:

- used with PUDHN suspension base
- for mounting, we offer SGFM12x30 bolts

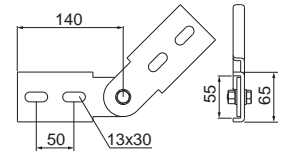

Angle Connector	LKDP	mat.: F	option: L	
code	catalogue number	weight 1 pc. [kg]	quantity per package [pcs.]	

Material thickness = 5.0 mm

LKDP	700421	0.89	10	
------	--------	------	----	--

Use:

Connecting DMC..., DM..., DDMC..., DDM..., DSH... vertical ladders. and DDH... travel angle.

Additional information:

- for mounting, we offer 4 sets of SGFM12x30 bolts
- LKDP and LGDP universal connectors fit DMC..., DM..., DDMC..., DDM..., DSH... and DDH... ladders

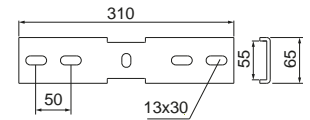

Articulated connector	LGDPH	mat.: F	option: L	
code	catalogue number	weight 1 pc. [kg]	quantity per package [pcs.]	N

Material thickness = 5.0 mm

LGDPH	700425	0.73	10	
-------	--------	------	----	--

Use:

Connecting DPH... I-beams at different angles.

Additional information:

- for mounting, we offer 2 sets of SGFM12x30 bolts

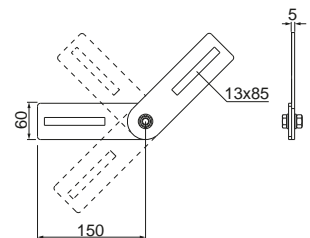

Angle Connector	LKDPH	mat.: F	option: L	
code	catalogue number	weight 1 pc. [kg]	quantity per package [pcs.]	N

Material thickness = 5.0 mm

LKDPH	700423	0.38	10	
-------	--------	------	----	--

Use:

Connecting DPH... I-beams at an angle.

Additional information:

- for mounting, we offer 2 sets of SGFM12x30 bolts

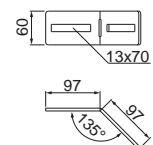

Cable Clip	UK1/UKO1...	mat.: FP	option: E		
code	catalogue number	dimension D _{min} /D _{max} /H [mm]	weight 1 pc. [kg]	quantity per package [pcs.]	
UK1/UKO1/8-12	404200	8/12/39	0.03	150	
UK1/UKO1/12-16	404300	12/16/43	0.04	150	
UK1/UKO1/16-22	402300	16/22/52	0.05	150	
UK1/UKO1/22-28	402400	22/28/59	0.06	150	
UK1/UKO1/28-34	402500	28/34/64	0.07	100	
UK1/UKO1/34-40	402600	34/40/70	0.08	100	
UK1/UKO1/40-46	402700	40/46/79	0.10	100	
UK1/UKO1/46-52	402800	46/52/90	0.11	100	
UK1/UKO1/52-58	402850	52/58/95	0.12	100	
UK1/UKO1/58-64	402900	58/64/99	0.13	100	
UK1/UKO1/64-70	404000	64/70/105	0.14	100	

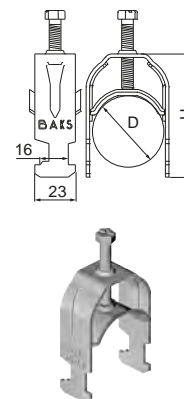

Use:
Cable mounting for DF..., DU..., DS... ladders, vertical ladders, SDOC..., SMSP... rungs as well as CMS...41H21 channels.

Additional information:
- RO1 protective trays are recommended

Cable Clip	UK2/UKO2...	mat.: FP	option: E		
code	catalogue number	dimension D _{min} /D _{max} /H [mm]	weight 1 pc. [kg]	quantity per package [pcs.]	
UK2/UKO2/8-12	403702	8/12/70	0.05	100	
UK2/UKO2/12-16	403703	12/16/74	0.05	100	
UK2/UKO2/16-22	403000	16/22/80	0.07	100	
UK2/UKO2/22-28	403100	22/28/90	0.09	100	
UK2/UKO2/28-34	403200	28/34/105	0.10	100	
UK2/UKO2/34-40	403300	34/40/118	0.12	100	
UK2/UKO2/40-46	403400	40/46/132	0.15	50	
UK2/UKO2/46-52	403500	46/52/149	0.16	50	
UK2/UKO2/52-58	403701	52/58/158	0.18	50	
UK2/UKO2/58-64	403600	58/64/163	0.20	50	
UK2/UKO2/64-70	403700	64/70/169	0.18	50	

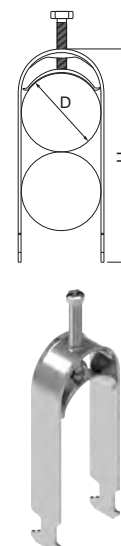

Use:
Cable mounting for DF..., DU..., DS... ladders, vertical ladders, SDOC..., SMSP... rungs as well as CMS...41H21 channels.

Additional information:
- RO1 protective trays are recommended
- SUK cable separators are recommended...



Cable Protection Piece		RO1...	mat.: FP	option: E	
code	catalogue number	use with	weight 1 pc. [kg]	quantity per package [pcs.]	
RO1/16-22	801500	UK1/UKO1/16-22; UKZ1/UKZO1/16-22	0.02	100	
RO1/22-28	801600	UK1/UKO1/22-28; UKZ1/UKZO1/22-28	0.02	100	
RO1/28-34	801700	UK1/UKO1/28-34; UKZ1/UKZO1/28-34	0.03	100	
RO1/34-40	801800	UK1/UKO1/34-40; UKZ1/UKZO1/34-40	0.03	100	
RO1/40-46	801900	UK1/UKO1/40-46; UKZ1/UKZO1/40-46	0.03	100	
RO1/46-52	802000	UK1/UKO1/46-52; UKZ1/UKZO1/46-52	0.04	100	
RO1/52-58	802201	UK1/UKO1/52-58; UKZ1/UKZO1/52-58	0.04	100	
RO1/58-64	802100	UK1/UKO1/58-64; UKZ1/UKZO1/58-64	0.05	100	
RO1/64-70	802300	UK1/UKO1/64-70; UKZ1/UKZO1/64-70	0.05	100	

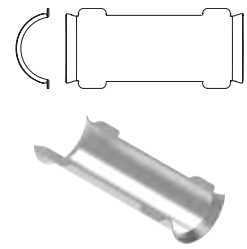

Use:

Additional protection for fixed cables.

Additional information:

- it is recommended to use a minimum of one protective tray when mounting the cable with the UKZ1... cable clamp on the side of wires in mesh trays
- it is recommended to use a minimum of one protective tray when mounting the cable with the UK1... or UKZ1... cable clamp (on the side of rungs in cable ladders)

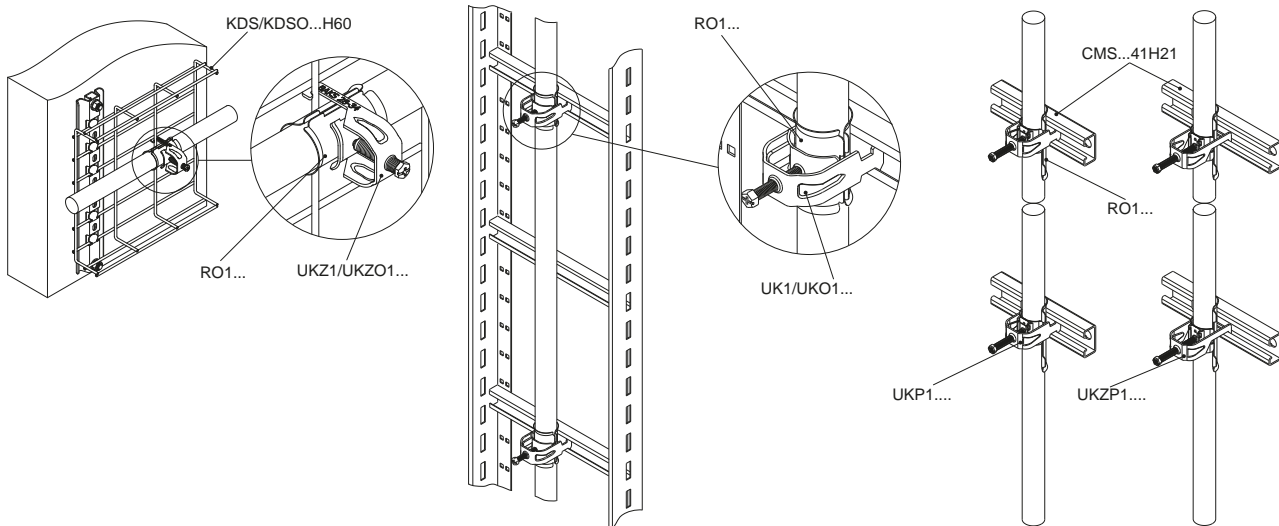

Cable separator		SUK2...	mat.: FP	option: E	
code	catalogue number	dimension D_{min}/D_{max} [mm]	weight 1 pc. [kg]	quantity per package [pcs.]	
SUK2/8-12	801448	8/12	0.01	100	
SUK2/12-16	801449	12/16	0.02	100	
SUK2/16-22	801501	16/22	0.02	100	
SUK2/22-28	801601	22/28	0.02	100	
SUK2/28-34	801701	28/34	0.03	100	
SUK2/34-40	801801	34/40	0.03	100	
SUK2/40-46	802101	40/46	0.03	100	
SUK2/46-52	802001	46/52	0.03	100	
SUK2/52-58	802202	52/58	0.04	100	
SUK2/58-64	802203	58/64	0.04	100	
SUK2/64-70	802204	64/70	0.04	100	

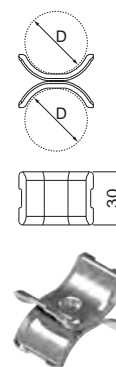

Use:

Separation of cables mounted in UK/UKO2... and UKZ/UKZO2... clamps

Additional information:

- safe cable clamping
- more stable mounting

Cable holder with plastic shell UKP1... mat.: FP option: E

code	catalogue number	dimension $D_{min}/D_{max}/H$ [mm]	weight 1 pc. [kg]	quantity per package [pcs.]
UKP1/8-12	425843	8/12/39	0.03	150
UKP1/12-16	425844	12/16/43	0.04	150
UKP1/16-22	425845	16/22/52	0.05	150
UKP1/22-28	425846	22/28/59	0.06	150
UKP1/28-34	425847	28/34/64	0.07	100
UKP1/34-40	425848	34/40/70	0.08	100
UKP1/40-46	425849	40/46/79	0.10	100
UKP1/46-52	425850	46/52/90	0.11	100
UKP1/52-58	425851	52/58/95	0.12	100
UKP1/58-64	425852	58/64/99	0.13	100
UKP1/64-70	425853	64/70/105	0.14	100

N

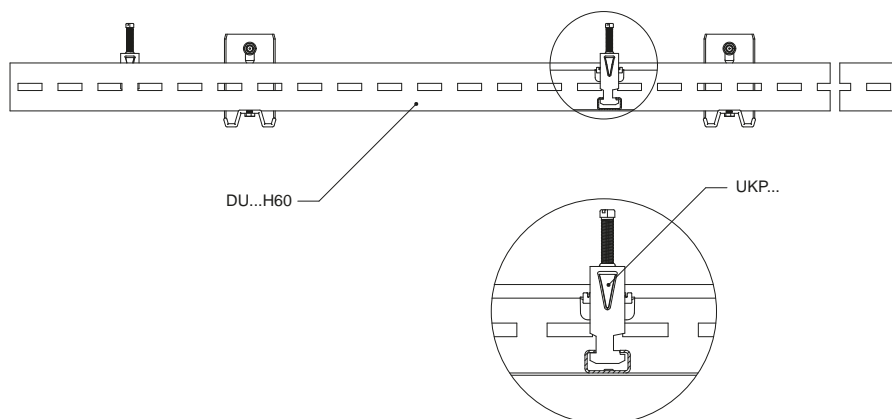
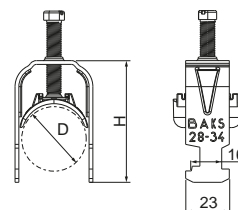

Cable holder with plastic shell UKP2... mat.: FP option: E

code	catalogue number	dimension $D_{min}/D_{max}/H$ [mm]	weight 1 pc. [kg]	quantity per package [pcs.]
UKP2/8-12	425854	8/12/70	0.07	100
UKP2/12-16	425855	12/16/76	0.07	100
UKP2/16-22	425856	16/22/80	0.07	100
UKP2/22-28	425857	22/28/90	0.09	100
UKP2/28-34	425858	28/34/105	0.10	100
UKP2/34-40	425859	34/40/118	0.12	100
UKP2/40-46	425860	40/46/132	0.15	50
UKP2/46-52	425861	46/52/149	0.16	50
UKP2/52-58	425862	52/58/158	0.18	50
UKP2/58-64	425863	58/64/164	0.19	50
UKP2/64-70	425864	64/70/170	0.20	50

N

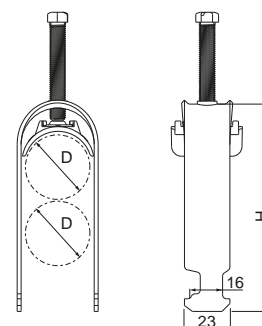

Use:

Cable mounting for DF..., DU..., DS... ladders, vertical ladders, SDOC..., SMSP... rungs as well as CMS...41H21 channels.

Additional information:

- bracket shell is made of polyethylene
- RO1 protective trays are recommended
- SUKP... cable separators are recommended

Cable separator	SUKP...	mat.: PP		
code	catalogue number	dimension D _{min} /D _{max} [mm]	weight 1 pc. [kg]	quantity per package [pcs.]
SUKP/8-12	803250	8/12	0.02	100
SUKP/12-16	803251	12/16	0.02	100
SUKP/16-22	803252	16/22	0.02	100
SUKP/22-28	803253	22/28	0.02	100
SUKP/28-34	803254	28/34	0.03	100
SUKP/34-40	803255	34/40	0.03	100
SUKP/40-46	803256	40/46	0.03	100
SUKP/46-52	803257	46/52	0.03	100
SUKP/52-58	803258	52/58	0.04	100
SUKP/58-64	803259	58/64	0.04	100
SUKP/64-70	803260	64/70	0.04	100

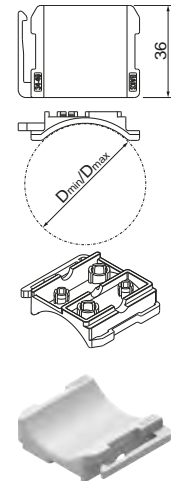

Use:
Separation of cables mounted in all BAKS type UK... cable clamps

Additional information:

- protection of cables from damage when pressing against supporting elements (e.g., the rung of the cable ladder or the wires of the mesh tray)
- safe cable clamping
- more stable mounting
- visually pleasant installation
- low price

Diagram showing 2 applications of the separator:

- A** - separation of the cable from the bottom of the supporting element (cable ladder rung, - C, self-supporting ladder - C, self-supporting tray, wire mesh tray - D)
- B** - separation between the cables using 2 elements permanently connected to each other by means of special clamps

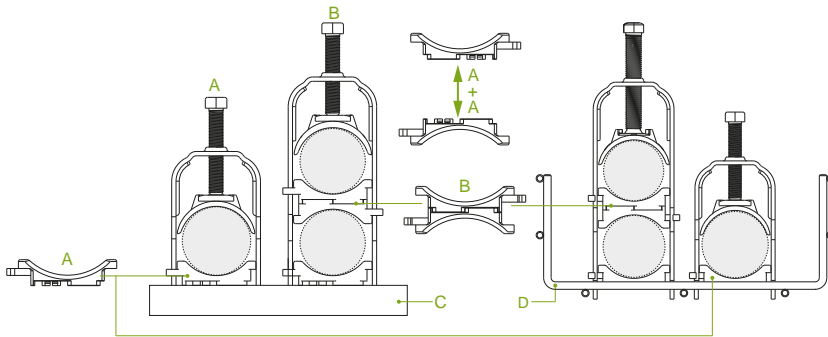

Angle adapter – Beam	PKDH	mat.: F		option: E, L
code	catalogue number	weight 1 pc. [kg]	quantity per package [pcs.]	
Material thickness = 5.0 mm				
PKDH	461006	0.36	10	

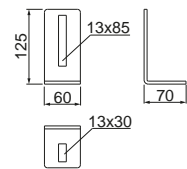

Use:
Mounting I-beams to the wall, ceiling or floor.
Fits DSH... and DDH... vertical ladders

Additional information:

- for mounting with I-beam, use 1 set of SGFM12x30 bolts

Head Plate	PSDHN	mat.: F		option: L
code	catalogue number	weight 1 pc. [kg]	quantity per package [pcs.]	
PSDHN	741316	1.90	10	

Additional information:

- for mounting, we offer SGFM12x30 bolts

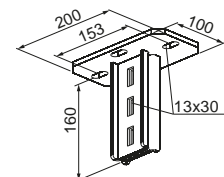

Head Plate	PUDHN	mat.: F	option: L	
code	catalogue number	weight 1 pc. [kg]	quantity per package [pcs.]	
PUDHN	741408	1.64	20	

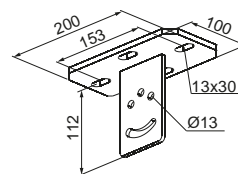

Use:

Used in conjunction with I-beam for suspending cable routes.

Additional information:

- base suitable for suspending vertical ladders to sloped ceilings
- for mounting, we offer SGFM12x30 bolts

Fastening Bracket	PSTV	mat.: FP	option: E, L	
code	catalogue number	load max. F_{max} [kN]	weight 1 pc. [kg]	quantity per package [pcs.]
Material thickness = 5.0 mm				
PSTV	740711	7.00	0.53	20

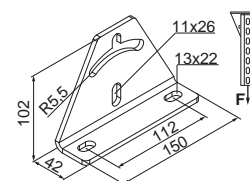

Use:

Suspending cable routes to the ceiling using channels.

Additional information:

- can be mounted to ceilings at an angle

Angle Bracket for Cable Ladder	LCKD	mat.: FP	option: F, E, L	
code	catalogue number	weight 1 pc. [kg]	quantity per package [pcs.]	
Material thickness = 4.0 mm				
LCKD	461005	0.31	10	

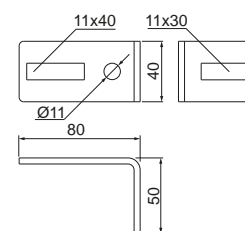

Use:

Mounting cable ladders vertically and horizontally flat to the wall.

Additional information:

- mounting with M8x16 bolts

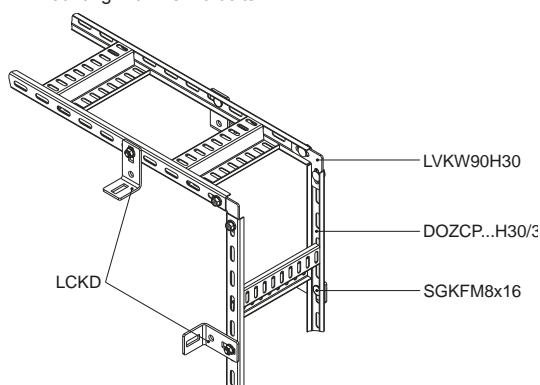



Fastening Bracket	UT	mat.: S	option: F, E, L	
code	catalogue number	weight 1 pc. [kg]	quantity per package [pcs.]	
Material thickness = 2.0 mm				
UT	751600	0.23	50	

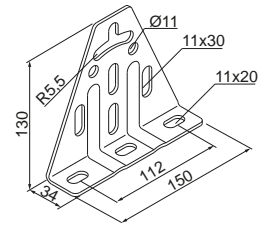

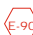
Fastening Bracket	UTM/UTMO	mat.: S	option: F, E, L	
code	catalogue number	weight 1 pc. [kg]	quantity per package [pcs.]	
Material thickness = 2.0 mm				
UTM/UTMO	751700	0.17	100	

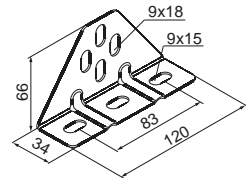

Use:
Installing trays and ladders at the proper distance from the wall. Mounting vertical ladders.



Example of mounting of a DUVC...H60/3 vertical ladder to a wall with UTM/UTMO brackets

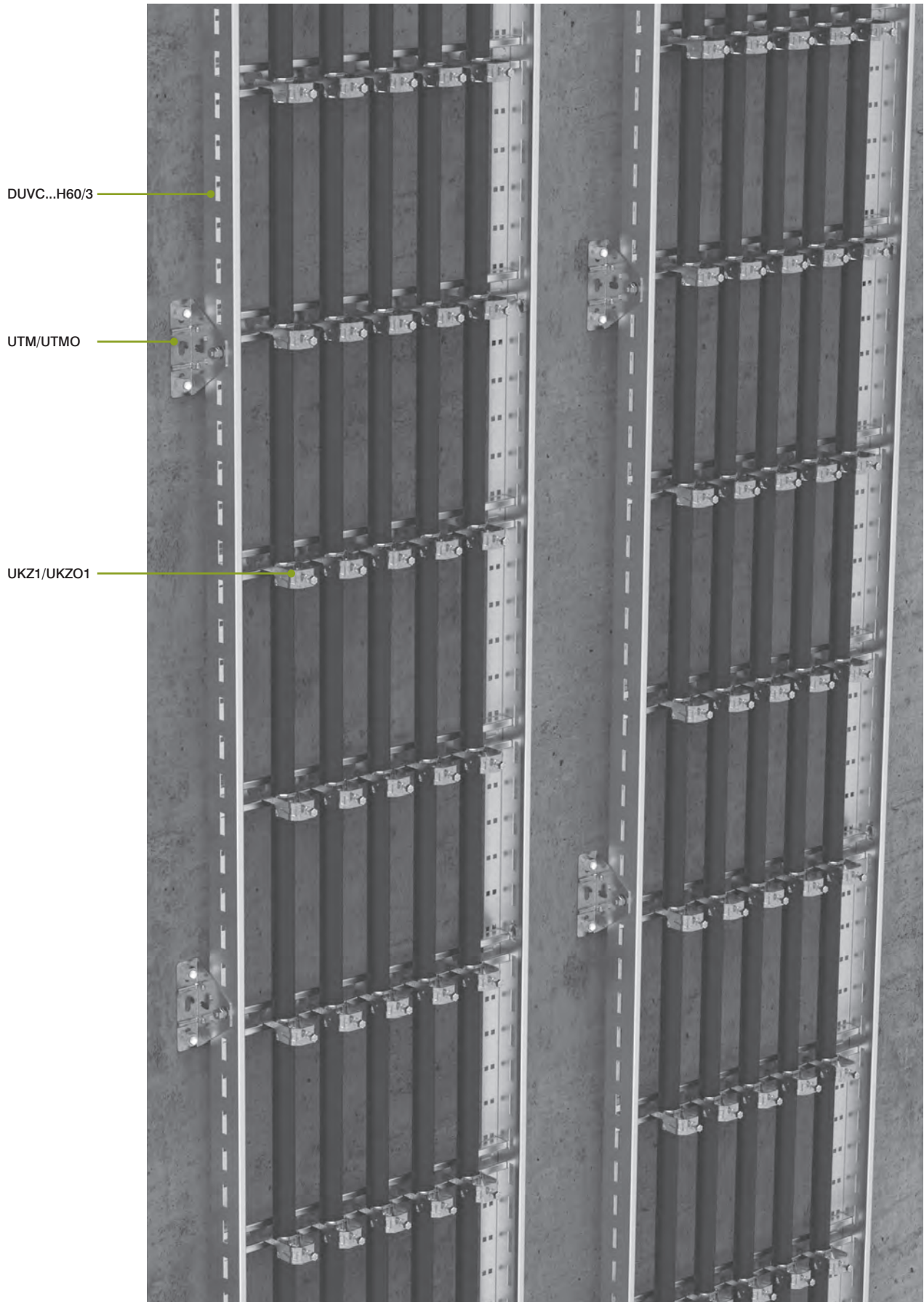



Example of vertical ladder installation with LCKD holder

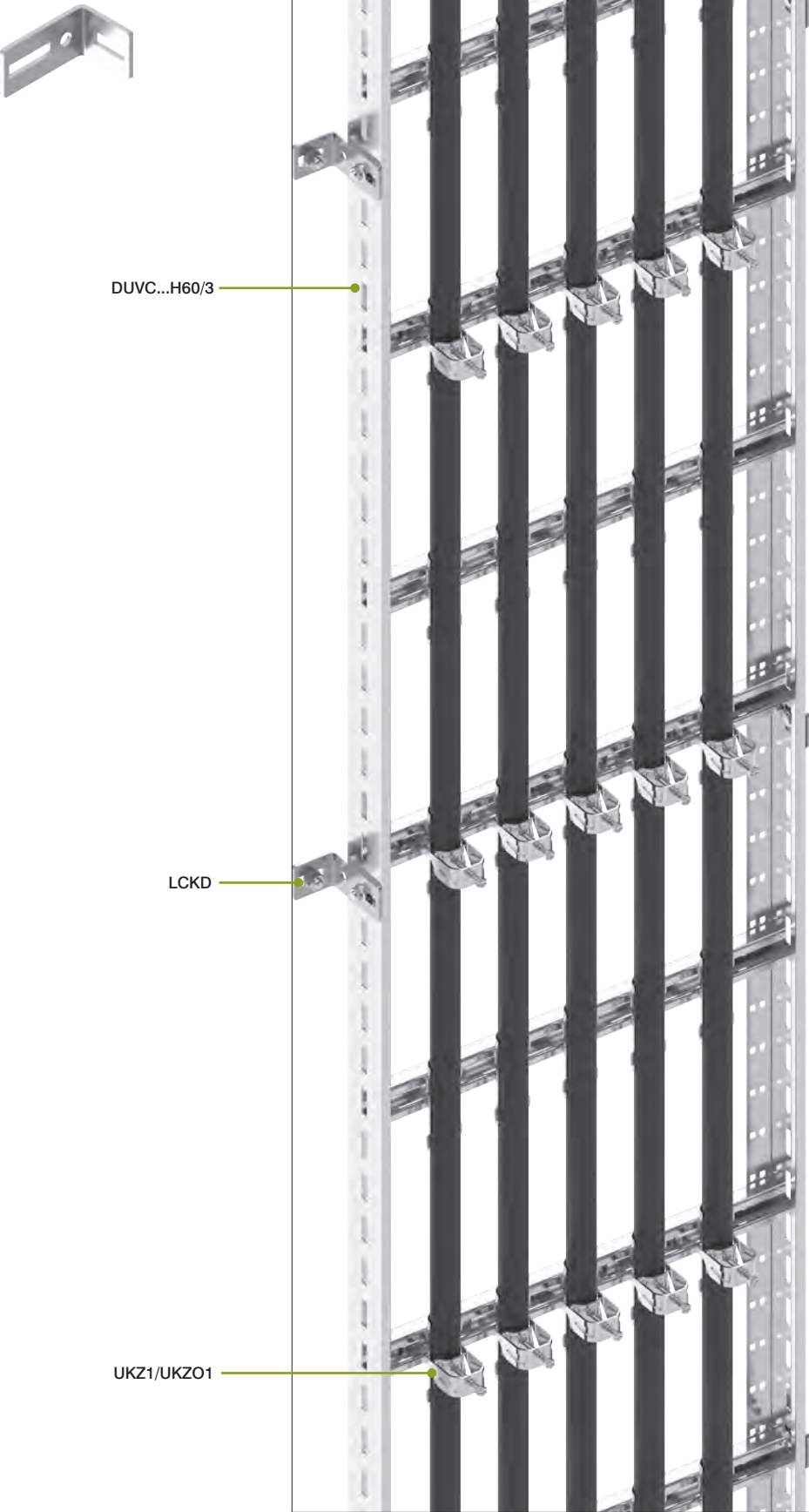

Example of installation of DSH... vertical ladder to the wall using NKH fastening clamp

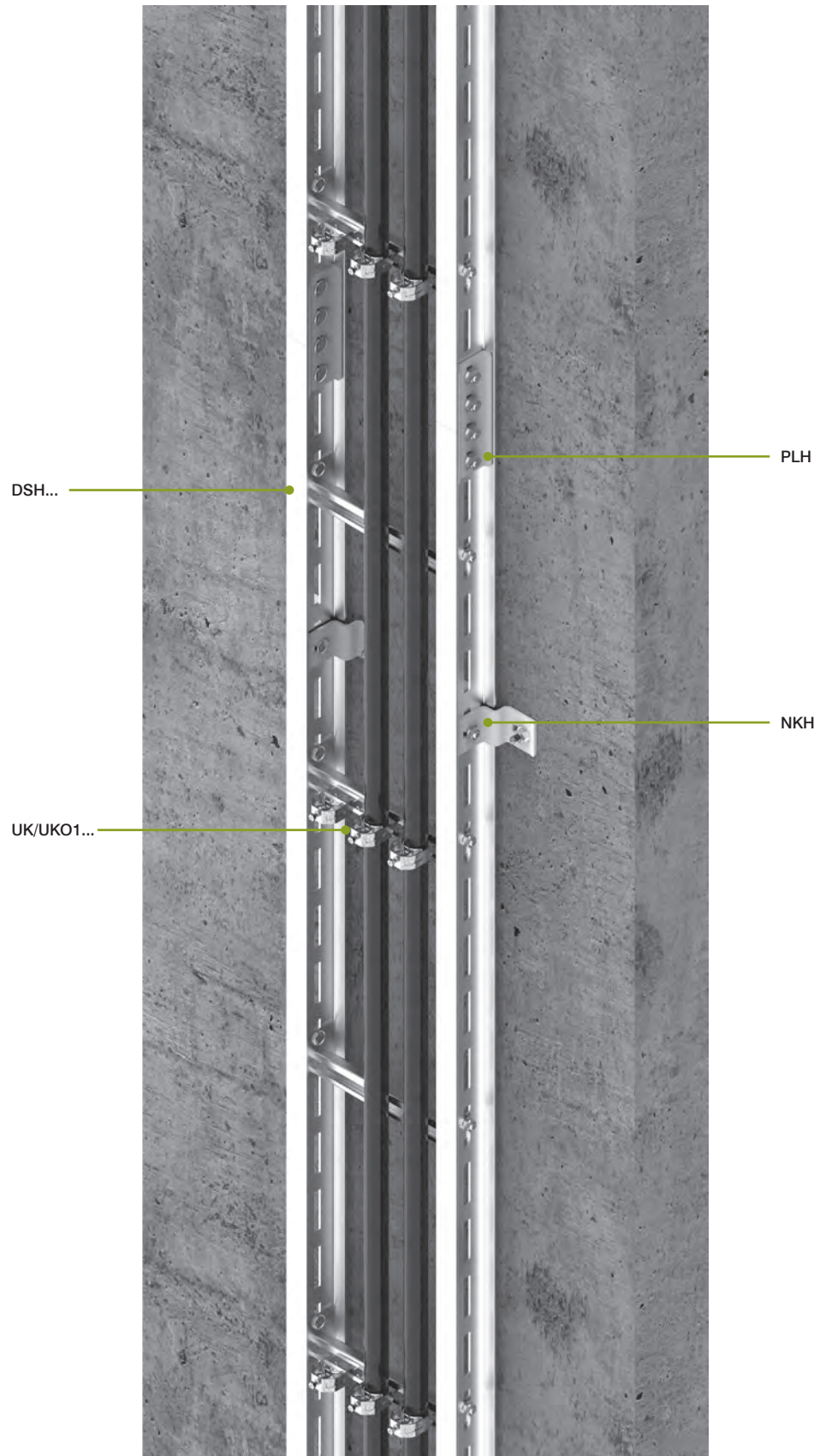

Example of installation of DDH...vertical ladder to the sloping ceiling and floor with PUDHN head plate, PDH connection piece, and PSDHN head plate

